

IDAHO DEPARTMENT OF WATER RESOURCES
Proof Report

8/7/2020

Water Permit 47-8095

Owner Type Name and Address
Status: Lapsed

Source

Tributary

<u>Beneficial Use</u>	<u>From</u>	<u>To</u>	<u>Diversion Rate</u>	<u>Volume</u>
-----------------------	-------------	-----------	-----------------------	---------------

Source and Point(s) of Diversion

Place Of Use

Conditions of Approval:

Comments:

Dates and Other Information

Water District Number: TBD

Mitigation Plan: False

Combined Use Limits

N/A

SubCase:

N/A

Water Supply Bank:

N/A



RECEIVED
Form 202
6/85

FEB 07 1989

Department of Water Resources
Southern Region Office

STATE OF IDAHO
DEPARTMENT OF WATER RESOURCES
APPLICATION FOR PERMIT

Ident. No. 47-08095

APPROVED

To appropriate the public waters of the State of Idaho

1. Name of applicant Robert Snedigar Phone _____

Post office address Route 4, Buhl, Idaho 83316

2. Source of water supply springs which is a tributary of Silo Creek

3. Location of point of diversion is NE $\frac{1}{4}$ of LOT 2 $\frac{1}{4}$ of NW (NESWW) $\frac{1}{4}$, Govt. Lot 2

Sec. 7 Township 9 S Range 15 E B.M. Twin Falls County; additional points of diversion if any: _____

4. Water will be used for the following purposes:

Amount 3 for fish propagation purposes from Jan 1 to Dec 31 (both dates inclusive)
(cfs or acre-feet per annum)

Amount _____ for _____ purposes from _____ to _____ (both dates inclusive)
(cfs or acre-feet per annum)

Amount _____ for _____ purposes from _____ to _____ (both dates inclusive)
(cfs or acre-feet per annum)

Amount _____ for _____ purposes from _____ to _____ (both dates inclusive)
(cfs or acre-feet per annum)

5. Total quantity to be appropriated is (a) 3.0 and/or (b) _____
cubic feet per second acre feet per annum

6. Proposed diverting works:

a. Description of ditches, flumes, pumps, headgates, etc. Collection ditch of earth to cement headworks, pipe to hatchery building and raceways.

b. Height of storage dam N/A feet; active reservoir capacity _____ acre-feet; total reservoir capacity _____ acre-feet; period of year when water will be diverted to storage: _____ to _____ inclusive.

c. Proposed well diameter is _____ inches; proposed depth of well is _____ feet.

d. Is ground water with a temperature of greater than 90°F being sought? _____

7. Time required for the completion of the works and application of the water to the proposed beneficial use is 4 years (minimum 1 year).

47-08095

8. Description of proposed uses (if irrigation only, go to item 9):

- a. Hydropower; show total feet of head and proposed capacity in KW. _____
- b. Stockwatering; list number and kind of livestock. _____
- c. Municipal; show name of municipality. _____
- d. Domestic; show number of households. _____
- e. Other; describe fully. FISH PROPAGATION (HATCHERY SITE)

9. Description of place of use:

- a. If water is for irrigation, indicate acreage in each subdivision in the tabulation below.
- b. If water is used for other purposes, place a symbol of the use (example: D for Domestic) in the corresponding place of use below. See instructions for standard symbols.

TWP	RANGE	SEC.	NE¼				NW¼				SW¼				SE¼				TOTALS
			NE¼	NW¼	SW¼	SE¼	NE¼	NW¼	SW¼	SE¼	NE¼	NW¼	SW¼	SE¼	NE¼	NW¼	SW¼	SE¼	
9S	15E	7							H										.1

Total number of acres to be irrigated _____

10. Describe any other water rights used for the same purposes as described above. No other rights being used at this location or on same property for hatchery purposes.

11. a. Who owns the property at the point of diversion? Applicant Applicant has other fish propagation, irrigation and hydro generation rights on property.

- b. Who owns the land to be irrigated or place of use? Applicant
- c. If the property is owned by a person other than the applicant, describe the arrangement enabling the applicant to make this filing. N/A

12. Remarks: Proposal is to build a small hatchery building with interior fry and swimup ponds and exterior raceways for swim up and fingerlings.

13. Map of proposed project: show clearly the proposed point of diversion, place of use, section number, township and range number.

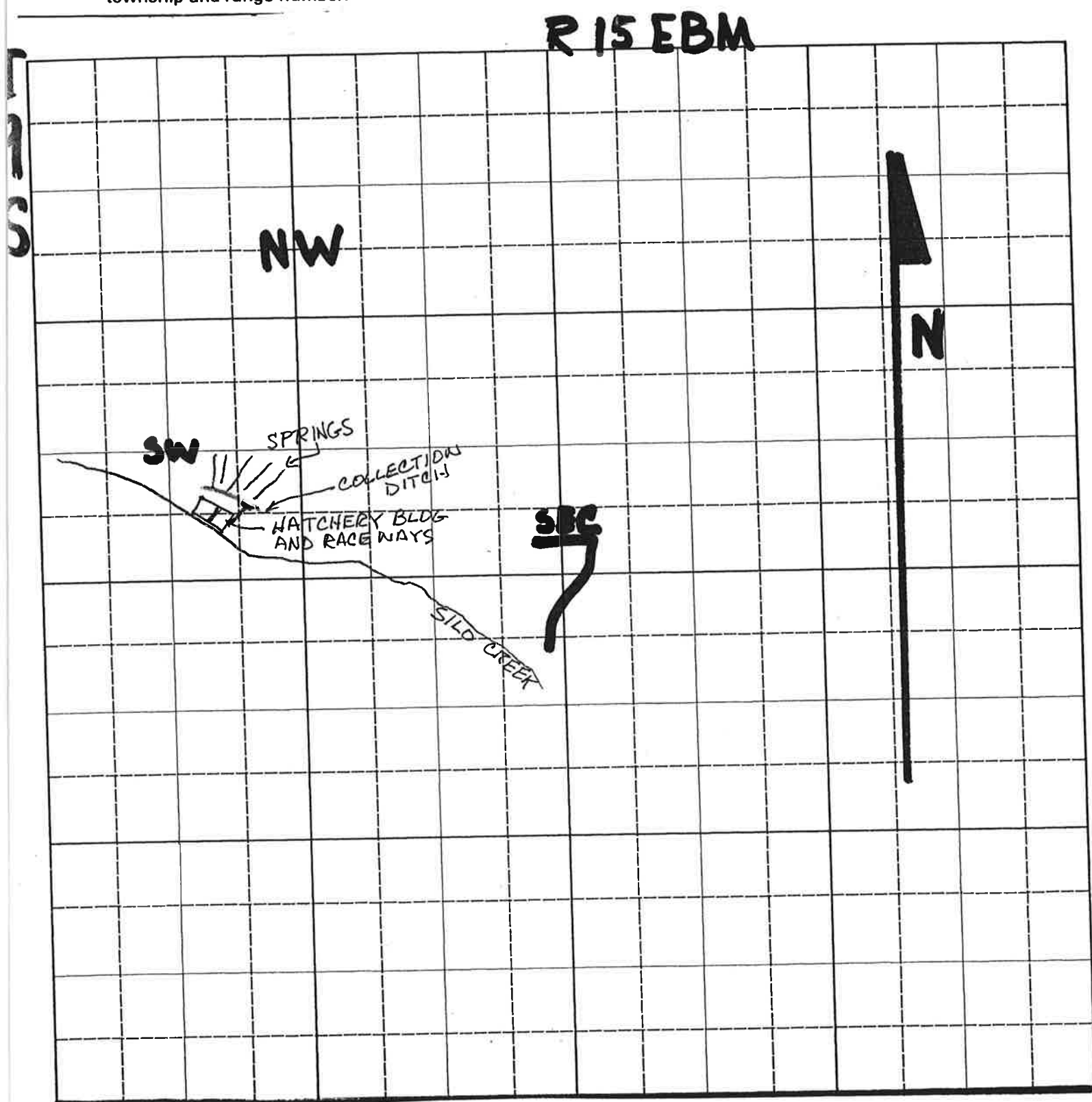

BE IT KNOWN that the undersigned hereby makes application for permit to appropriate the public waters of the State of Idaho as herein set forth.

Robert Smedigan
(Applicant)

Proposed Priority 4/19/88

5/12/88

Received by T. Blau Date 4/19/88 Time 3:45p Preliminary check by GP

Fee \$ 85⁰⁰ Receipted by T. Blau # 5000106 Date 4/19/88

Publication prepared by M. Baldwin Date 7/18/88 Published in Times News

Publication approved _____ Date _____

ACTION OF THE DIRECTOR, DEPARTMENT OF WATER RESOURCES

This is to certify that I have examined Application for Permit to appropriate the public waters of the State of Idaho No. 47-8095, and said application is hereby APPROVED.

1. Approval of said application is subject to the following limitations and conditions:

a. SUBJECT TO ALL PRIOR WATER RIGHTS.

b. Proof of construction of works and application of water to beneficial use shall be submitted on or before March 1, 19 93.

c. The rate of diversion, if water is to be used for irrigation under this permit, when combined with all other water rights for the same land shall not exceed 0.02 cubic feet per second for each acre of land.

d. The water right acquired under this permit if for hydropower purposes shall be junior and subordinate to all rights to the use of water, other than hydropower, within the State of Idaho that are initiated later in time than the priority of this permit and shall not give rise to any right or claim against any future rights to the use of water, other than hydropower, within the State of Idaho initiated later in time than the priority of this permit.

e. Other:

The permit holder shall be required to provide the Department, upon request, information showing volume changes per hour necessary to maintain an adequate environment for the fish propagation facility. Volume changes per hour shall be based upon actual fish production.

Use of water under this right is subject to policies set forth in the State of Idaho Water Plan, including Policy No. 5G.

Use of water under this permit shall be non-consumptive.

Permit holder shall commence the excavation or construction of diverting works within one year of the date this permit is issued and shall proceed diligently until the project is complete.

Measuring devices of a type approved by the Department shall be permanently installed and maintained at the point of diversion and the point of effluent discharge.

Assignment or sale of this permit is subject to a determination by the Department that the permit holder has proceeded to develop the permit with due diligence and without speculation.

Water used under this permit if discharged into a natural channel shall meet Idaho Water Quality Standards.

Witness my hand this 3rd day of February, 1989.

A. Glen Saxton