

IDAHO DEPARTMENT OF WATER RESOURCES  
Proof Report

8/7/2020

Water Permit 47-8114

<u>Owner Type</u>	<u>Name and Address</u>
Current Owner	US DEPT OF INTERIOR , ID

Status: Lapsed

<u>Source</u>	<u>Tributary</u>
---------------	------------------

<u>Beneficial Use</u>	<u>From</u>	<u>To</u>	<u>Diversion Rate</u>	<u>Volume</u>
-----------------------	-------------	-----------	-----------------------	---------------

Source and Point(s) of Diversion

Place Of Use

Conditions of Approval:

Comments:

Dates and Other Information

Water District Number: TBD  
Mitigation Plan: False

Combined Use Limits

N/A

SubCase:

N/A

Water Supply Bank:

N/A

RECEIVED  
JUN - 9 1988

STATE OF IDAHO

Ident. No. 47-08114

DEPARTMENT OF WATER RESOURCES

no # encl.  
Department of Water Resources

APPLICATION FOR PERMIT

To appropriate the public waters of the State of Idaho

RECEIVED

JUL 13 1988  
334-1582

1. Name of applicant USDI-Bureau of Land Management Phone 334-1582  
Post office address 3948 Development Ave., Boise, Idaho, 83705 Southern Region Office

2. Source of water supply Groundwater which is a tributary of NA

3. Location of point of diversion is SW  $\frac{1}{4}$  of SE  $\frac{1}{4}$  of SE  $\frac{1}{4}$ , Govt. Lot NA  
Sec. 20 Township 7S Range 13E B.M. Twin Falls County; additional  
points of diversion if any: None

4. Water will be used for the following purposes:

Amount 0.02 for Domestic purposes from Jan. 1 to Dec. 31 (both dates inclusive)  
(cfs or acre-feet per annum)

Amount \_\_\_\_\_ for \_\_\_\_\_ purposes from \_\_\_\_\_ to \_\_\_\_\_ (both dates inclusive)  
(cfs or acre-feet per annum)

Amount \_\_\_\_\_ for \_\_\_\_\_ purposes from \_\_\_\_\_ to \_\_\_\_\_ (both dates inclusive)  
(cfs or acre-feet per annum)

Amount \_\_\_\_\_ for \_\_\_\_\_ purposes from \_\_\_\_\_ to \_\_\_\_\_ (both dates inclusive)  
(cfs or acre-feet per annum)

5. Total quantity to be appropriated is (a) 0.02 and/or (b) 14.48  
cubic feet per second acre feet per annum

6. Proposed diverting works:

a. Description of ditches, flumes, pumps, headgates, etc. Well

b. Height of storage dam NA feet; active reservoir capacity \_\_\_\_\_ acre-feet; total  
reservoir capacity \_\_\_\_\_ acre-feet; period of year when water will be diverted to storage:  
\_\_\_\_\_ to \_\_\_\_\_ inclusive.

c. Proposed well diameter is 6" inches; proposed depth of well is 650' feet.

d. Is ground water with a temperature of greater than 90°F being sought? No

7. Time required for the completion of the works and application of the water to the proposed beneficial use is  
5 years (minimum 1 year).

47-08114-47

8. Description of proposed uses (if irrigation only, go to item 9):

- a. Hydropower; show total feet of head and proposed capacity in KW. NA
- b. Stockwatering; list number and kind of livestock. NA
- c. Municipal; show name of municipality. NA
- d. Domestic; show number of households. ONE PUBLIC RESTROOM WITH SHOWERS
- e. Other; describe fully. NA

9. Description of place of use:

- a. If water is for irrigation, indicate acreage in each subdivision in the tabulation below.
- b. If water is used for other purposes, place a symbol of the use (example: *D* for Domestic) in the corresponding place of use below. See instructions for standard symbols.

TWP	RANGE	SEC.	NE¼				NW¼				SW¼				SE¼				TOTALS
			NE¼	NW¼	SW¼	SE¼	NE¼	NW¼	SW¼	SE¼	NE¼	NW¼	SW¼	SE¼	NE¼	NW¼	SW¼	SE¼	
7S	13E	20																D	

Total number of acres to be irrigated 0

10. Describe any other water rights used for the same purposes as described above. None

11. a. Who owns the property at the point of diversion? USDI-Bureau of Land Management
- b. Who owns the land to be irrigated or place of use? USDI-Bureau of Land Management
- c. If the property is owned by a person other than the applicant, describe the arrangement enabling the applicant to make this filing. NA

12. Remarks: Identified water needs are for a public restroom and shower facility that would handle day use and over night camping. This project is known as the Hagerman Landmark central overlook facility.

13. Map of proposed project: show clearly the proposed point of diversion, place of use, section number, township and range number.

T. 7 S. R. 13 E.

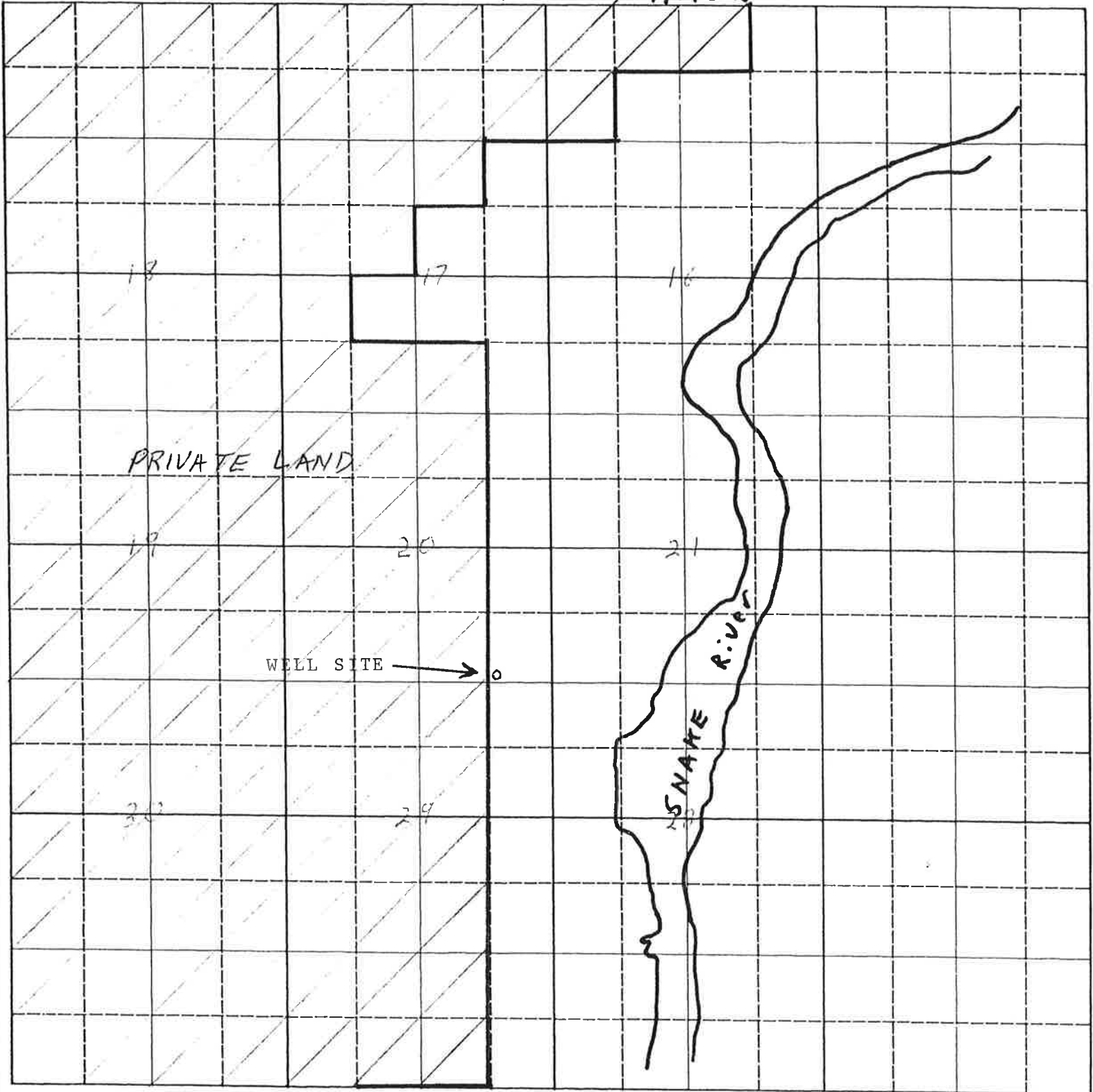

Scale: 2 inches equal 1 mile.

BE IT KNOWN that the undersigned hereby makes application for permit to appropriate the public waters of the State of Idaho as herein set forth.

JARBIDGE AREA MANAGER

*Sandy Carson* 6-2-88  
(Applicant)

*For the Board of Control*

Received by MB Date 7/13/88 Time 10:00 Proposed Priority 6/9/88  
" CD Date 6-9-88 Time 11:38a Preliminary check by AS  
ID-910-BP8-0010  
Fee \$ 30.00 Receipted by RG # C002066 Date 7/24/88  
Publication prepared by M. Baldwin Date 10/20/88 Published in Times News  
Publication approved M. Baldwin Date 11/23/88

### ACTION OF THE DIRECTOR, DEPARTMENT OF WATER RESOURCES

This is to certify that I have examined Application for Permit to appropriate the public waters of the State of Idaho No. 47-8114, and said application is hereby APPROVED.

1. Approval of said application is subject to the following limitations and conditions:

a. SUBJECT TO ALL PRIOR WATER RIGHTS.

b. Proof of construction of works and application of water to beneficial use shall be submitted on or before March 1, 19 94.

c. The rate of diversion, if water is to be used for irrigation under this permit, when combined with all other water rights for the same land shall not exceed 0.02 cubic feet per second for each acre of land.

d. The water right acquired under this permit if for hydropower purposes shall be junior and subordinate to all rights to the use of water, other than hydropower, within the State of Idaho that are initiated later in time than the priority of this permit and shall not give rise to any right or claim against any future rights to the use of water, other than hydropower, within the State of Idaho initiated later in time than the priority of this permit.

e. Other:

Permit holder shall comply with the drilling permit requirements of Section 42-235, Idaho Code.

Permit holder shall commence the excavation or construction of diverting works within one year of the date this permit is issued and shall proceed diligently until the project is complete.

Witness my hand this 2<sup>nd</sup> day of February, 1989.

J. Newington