

IDAHO DEPARTMENT OF WATER RESOURCES
Proof Report

8/7/2020

Water Permit 47-8171

| <u>Owner Type</u> | <u>Name and Address</u> |
|-------------------|-------------------------|
| Current Owner | JOHNNIE KUEST , ZZ |

Status: Relinquished

Source

Tributary

Beneficial Use

From

To

Diversion Rate

Volume

Source and Point(s) of Diversion

Place Of Use

Conditions of Approval:

Comments:

Dates and Other Information

Water District Number: TBD

Mitigation Plan: False

Combined Use Limits

N/A

SubCase:

N/A

Water Supply Bank:

N/A

STATE OF IDAHO
DEPARTMENT OF WATER RESOURCES
APPLICATION FOR PERMIT

Ident. No. 47-08171

Date Sent to S.O. NOV 25 1991

To appropriate the public waters of the State of Idaho

1. Name of applicant Johnnie Kuest Phone (208) 326-4084
Post office address P.O. Box 110, Filer, ID 83328
2. Source of water supply Unnamed Stream which is a tributary of Snake River
3. Location of point of diversion is SW $\frac{1}{4}$ of SE $\frac{1}{4}$ of SE $\frac{1}{4}$, Govt. Lot _____
Sec. 32 Township 8S. Range 14E. B.M. Twin Falls County; additional
points of diversion if any: _____
4. Water will be used for the following purposes:
Amount .15 for IRRIGATION purposes from MAR 15 to NOV 15 (both dates inclusive)
(cfs or acre-feet per annum)
Amount _____ for _____ purposes from _____ to _____ (both dates inclusive)
(cfs or acre-feet per annum)
Amount _____ for _____ purposes from _____ to _____ (both dates inclusive)
(cfs or acre-feet per annum)
Amount _____ for _____ purposes from _____ to _____ (both dates inclusive)
(cfs or acre-feet per annum)
5. Total quantity to be appropriated is (a) .15 cubic feet per second and/or (b) _____ acre feet per annum
6. Proposed diverting works:
a. Description of ditches, flumes, pumps, headgates, etc. Existing pump + ditches

b. Height of storage dam _____ feet; active reservoir capacity _____ acre-feet; total
reservoir capacity _____ acre-feet; period of year when water will be diverted to storage:
_____ to _____ inclusive.
c. Proposed well diameter is _____ inches; proposed depth of well is _____ feet.
d. Is ground water with a temperature of greater than 90°F being sought? _____
7. Time required for the completion of the works and application of the water to the proposed beneficial use is
1 yr years (minimum 1 year).

47-8171

8. Description of proposed uses (if irrigation only, go to item 9):

- Hydropower; show total feet of head and proposed capacity in KW. _____
- Stockwatering; list number and kind of livestock. _____
- Municipal; show name of municipality. _____
- Domestic; show number of households. _____
- Other; describe fully. _____

9. Description of place of use:

- If water is for irrigation, indicate acreage in each subdivision in the tabulation below.
- If water is used for other purposes, place a symbol of the use (example: *D* for *Domestic*) in the corresponding place of use below. See instructions for standard symbols.

| TWP | RANGE | SEC. | NE¼ | | | | NW¼ | | | | SW¼ | | | | SE¼ | | | | TOTALS |
|-----|-------|------|-----|-----|-----|-----|-----|-----|-----|-----|-----|-----|-----|-----|-----|-----|-----|-----|--------|
| | | | NE¼ | NW¼ | SW¼ | SE¼ | NE¼ | NW¼ | SW¼ | SE¼ | NE¼ | NW¼ | SW¼ | SE¼ | NE¼ | NW¼ | SW¼ | SE¼ | |
| 8S | 14E | 32 | | | | | | | | | | | | | | | | 5 | 5 |
| | | | | | | | | | | | | | | | | | | | |
| | | | | | | | | | | | | | | | | | | | |
| | | | | | | | | | | | | | | | | | | | |
| | | | | | | | | | | | | | | | | | | | |
| | | | | | | | | | | | | | | | | | | | |
| | | | | | | | | | | | | | | | | | | | |
| | | | | | | | | | | | | | | | | | | | |
| | | | | | | | | | | | | | | | | | | | |
| | | | | | | | | | | | | | | | | | | | |

Total number of acres to be irrigated 5

10. Describe any other water rights used for the same purposes as described above. _____

- Who owns the property at the point of diversion? Applicant
- Who owns the land to be irrigated or place of use? Same
- If the property is owned by a person other than the applicant, describe the arrangement enabling the applicant to make this filing. _____

12. Remarks: _____

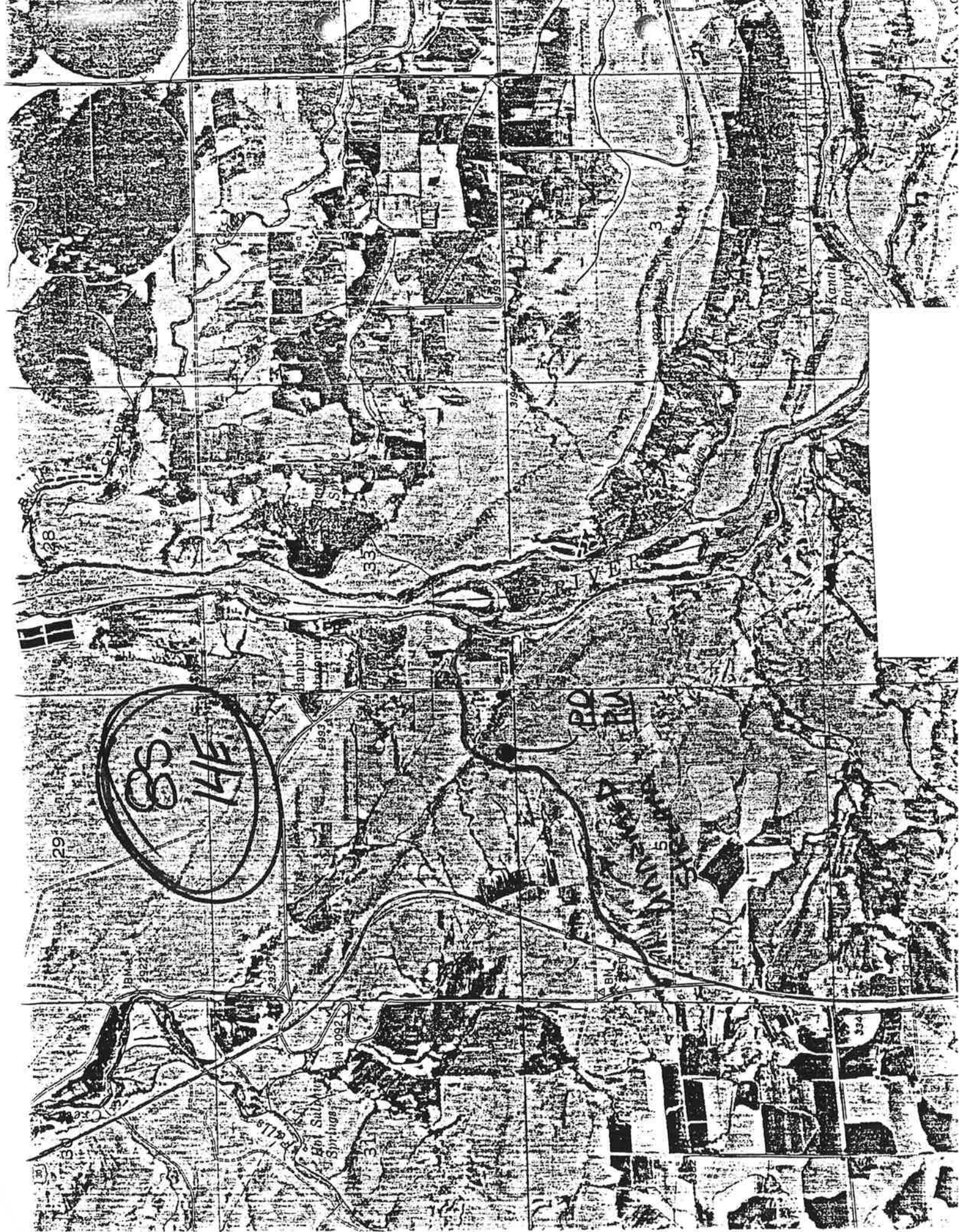

Received by SCC Date 12/8/88 Time 10:00 Am Preliminary check by JB
Fee \$ 30⁰⁰ Received by SCC # 5004341 Date 12/8/88
Publication prepared by _____ Date _____ Published in _____
Publication approved _____ Date _____

ACTION OF THE DIRECTOR, DEPARTMENT OF WATER RESOURCES

This is to certify that I have examined Application for Permit to appropriate the public waters of the State of Idaho No. _____, and said application is hereby _____.

1. Approval of said application is subject to the following limitations and conditions:

- a. SUBJECT TO ALL PRIOR WATER RIGHTS.
- b. Proof of construction of works and application of water to beneficial use shall be submitted on or before _____, 19 ____.
- c. The rate of diversion, if water is to be used for irrigation under this permit, when combined with all other water rights for the same land shall not exceed 0.02 cubic feet per second for each acre of land.
- d. The water right acquired under this permit if for hydropower purposes shall be junior and subordinate to all rights to the use of water, other than hydropower, within the State of Idaho that are initiated later in time than the priority of this permit and shall not give rise to any right or claim against any future rights to the use of water, other than hydropower, within the State of Idaho initiated later in time than the priority of this permit.
- e. Other: