

STATE OF IDAHO
DEPARTMENT OF WATER RESOURCES
BENEFICIAL USE FIELD REPORT

A. GENERAL INFORMATION

Permit No: 95-17847
Exam Date: 10/01/2020

1. Current Owner:
TRAVIS R BURGUS 14808 E 48TH LN VERADALE WA 99037-8701 AND
JENNIFER L BURGUS 14808 E 48TH LN VERADALE WA 99037-8701
2. Accompanied by: In house
Phone No:
Address:
Relationship to permit Holder:

3. **SOURCE:** COEUR D ALENE LAKE Tributary
SPOKANE RIVER

Method of Determination: ____ application, permit ____

B. OVERLAP REVIEW

1. Other water rights with the same place of use: NO Overlap

Water Right No.	Source	Purpose of Use	Basis

Comments: there are two statutory claims for domestic that have the entire QQ as the shape. I do not believe these are appurtenant to this property.

2. Other water rights with the same point-of-diversion: NO Overlap

Water Right No.	Source	Purpose of Use	Basis

Comments: _____

C. DIVERSION AND DELIVERY SYSTEM1. **LOCATION OF POINT(S) OF DIVERSION:**

COEUR D ALENE LAKE SE¼ SW¼, Sec. 14, Twp 48N, Rge 04W, B.M. KOOTENAI County

Method of Determination: Application,, permit and ArcMap

PLACE OF USE: DOMESTIC

Twp	Rng	Sec	NE				NW				SW				SE				Totals
			NE	NW	SW	SE	NE	NW	SW	SE	NE	NW	SW	SE	NE	NW	SW	SE	
48N	04W	14												X L5					

Method of Determination: Application, permit and ArcMap

3. Delivery System Diagram Attached (required). Indicate all major components and distances between components. Indicate weir size/pipe as applicable.
- Map Attached Showing Location(s) of point(s) of diversion and place(s) of use (required). Scale must be 1:24,000 or greater.
- Aerial Photo Attached (required for irrigation of 10+ acres).
- Photo of Diversion and System Attached

4.

Well or Diversion ID No.*	Motor Make	Hp	Motor Serial No.	Pump Make	Pump Serial No. or Discharge Size

D. FLOW MEASUREMENTS

1.

Measurement Equipment	Type	Make	Model No.	Serial No.	Size	Calib. Date

2. Measurements:

E. FLOW CALCULATIONS

Additional Computation Sheets Attached

Measured Method:

F. VOLUME CALCULATIONS

1. Volume Calculations for irrigation:

$$V_{IR} = (\text{Acres Irrigated}) \times (\text{Irrigation Requirement}) =$$

$$V_{DR} = [\text{Diversion Rate (cfs)}] \times (\text{Days in Irrigation season}) \times 1.9835 =$$

$$V = \text{Smaller of } V_{IR} \text{ and } V_{DR} =$$

2. Volume Calculations for Other Uses: Domestic use with ½ acre of irrigation. 1.2 af per Administrative Application Processing Memo # 22 and application.

G. NARRATIVE/REMARKS/COMMENTS: ArcMap and Kootenai County show dwelling on property and list Burgus as current owner. POU is Lot 2, Block 1, Park Estates in Harrison, Id. xHouse appears to have been built in 2019. Lots of trees on the lot for watering. There are two statutory claims that are in the same QQ but don't believe they are appurtenant to this property, 95-4103 and 95-4426, neither were claimed in the NIA. Assume fish screen is installed with submission of proof.

Have conditions of permit approval been met? ☒ Yes ☐ No

H. RECOMMENDATIONS

1. Recommended Amounts

<u>Beneficial Use</u>	<u>Period of Use</u>	<u>Rate of Diversion</u>	<u>Annual Volume</u>
DOMESTIC	01/01 to 12/31	0.04 CFS	1.2 AF
<u>Totals:</u>		0.04 CFS	1.2 AF

2. Recommended Amendments

☐ Change P.D. as reflected above ☐ Add P.D. as reflected above ☒ None
☐ Change P.U. as reflected above ☐ Add P.U. as reflected above ☒ None

I. AUTHENTICATION

Jean Hersley - Technical Records Specialist 2

Field Examiner's Name Jean Hersley Date 10-1-2020

Reviewer Phane Date 10/15/20

Kootenai County, Idaho

generated on 10/1/2020 3:59:01 PM CDT

Parcel

Parcel Number 0K2300010020	AIN 319920	Situs Address 40917 S HIGHWAY 97, HARRISON	Data as of 9/26/2020
--------------------------------------	----------------------	--	--------------------------------

Owner Information

Owner Name	BURGUS TRAVIS BURGUS JENNIFER
Owner Address	14808 E 48TH LN VERADALE WA 99037
Transfer Date	10/05/2017
Document #	
Deed Book/Page	

Location / Description

Tax Authority Group	236000	Current Legal Desc.	PARK ESTATES, LT 2 BLK 1 1448N04W
Situs Address	40917 S HIGHWAY 97, HARRISON		
Acreage	.2048		

Parcel Type

Property Class Code	537- Imp res rural sub
Neighborhood Code	6103 CDA LAKE E SIDE-PWDRHRN-HALF R

Assessment Information

Appraisal Date	07-13-2020	Current Year	2020	Prior Year	2019
Market Value Land	\$211,845	Homeowners Eligible Amt Land	\$0	Homeowners Eligible Amt Land	\$0
Market Value Improvement	\$26,160	Homeowners Eligible Amt Imp	\$0	Homeowners Eligible Amt Imp	\$0
Total Market Value	\$238,005	Sum Homeowners Eligible Amt	\$0	Sum Homeowners Eligible Amt	\$0
		Homeowners Exemption Allowed	\$0	Homeowners Exemption Allowed	\$0
Acreage	0.2048	Total Market Value	\$238,005	Total Market Value	\$227,873
		Homeowners Exemption Allowed	\$0	Homeowners Exemption	\$0
		Ag/Timber Exemption	\$0	Ag/Timber Exemption	\$0
		Other Exemptions	\$0	Other Exemptions	\$0
		Net Taxable Value	\$238,005	Net Taxable Value	\$227,873

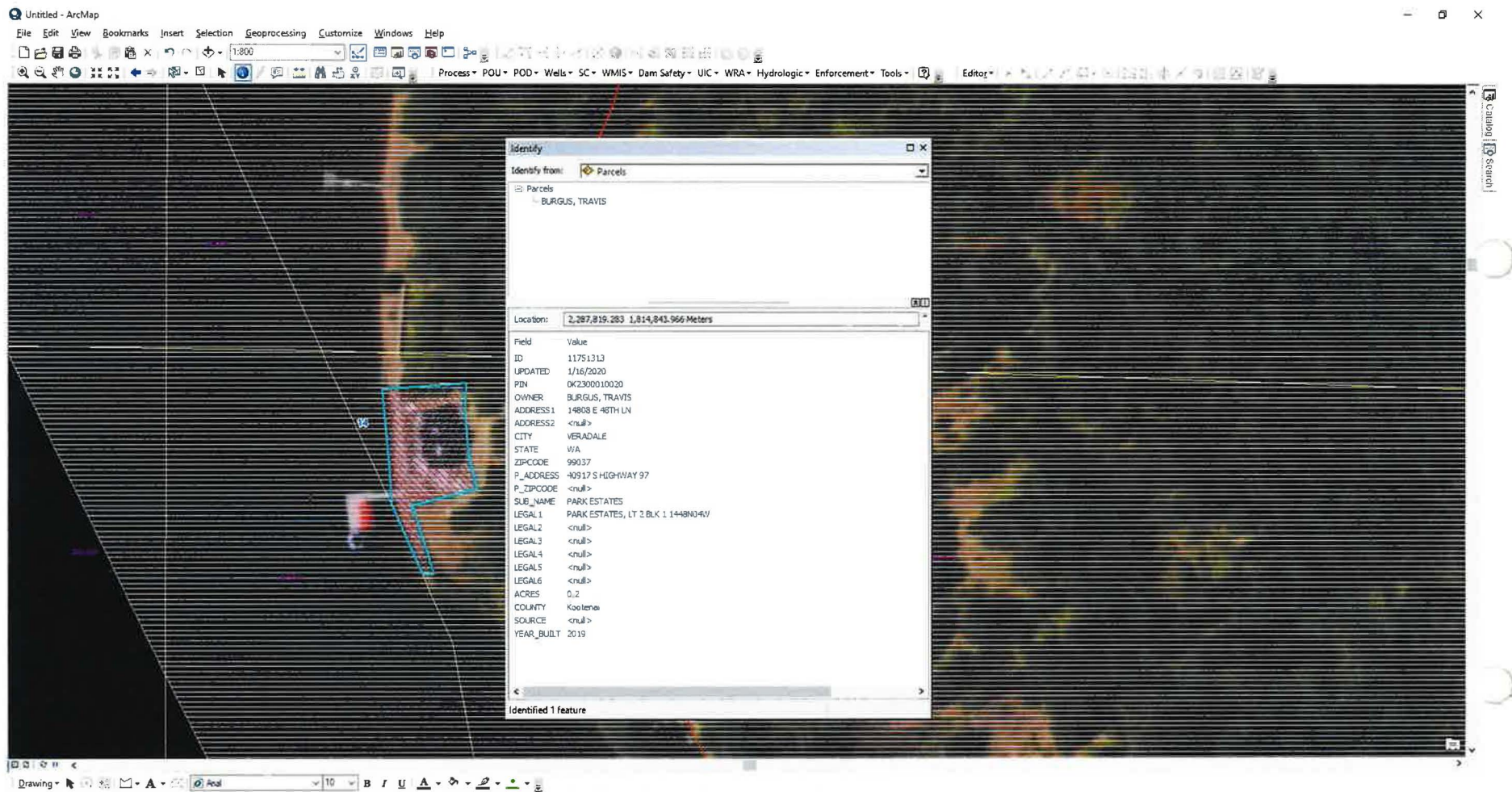

ArcMap shows dwelling and lists Burgus as current owner of property and year built as 2019

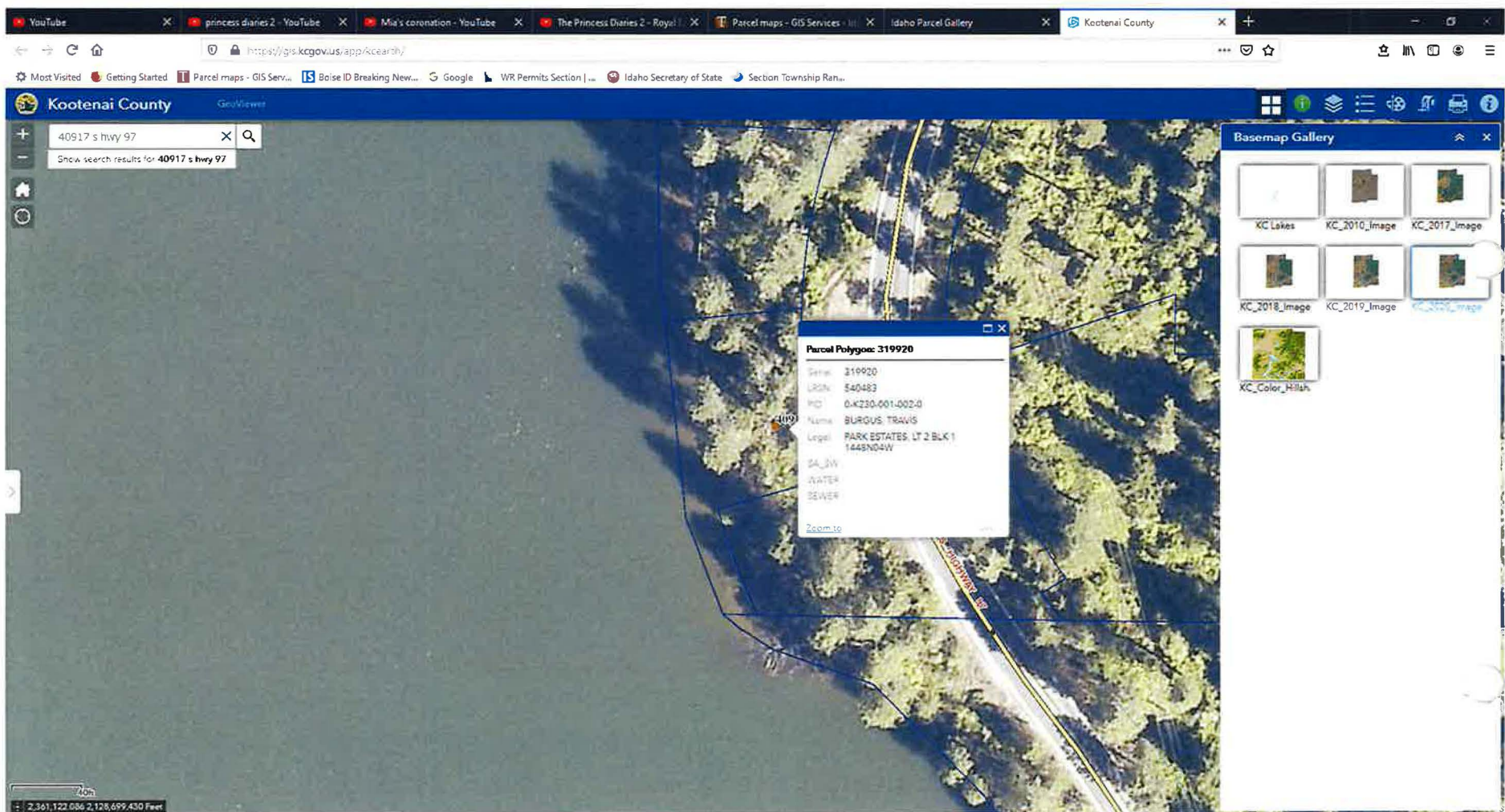

Kootenai County lists Burgus as current owner.