

February 20, 2020

To: James Cefelo

From: Members of Deep Canyon Creek

Water Right 13-53

The Deep Canyon Water Right users have been working together for many years. We have always got along very well. We have pitched in and made decisions together. We have built and maintained the pipelines together. We have shared the expenses and irrigation times fairly. The pooling agreement of 1983 shows the division of shares agreed upon. Since 1994 Steven Chatterton has kept the records of expenses and divisions of such according to shares. Payment of these expenses shows agreement of all users or members of this informal company. We have called meetings when needed and followed a schedule of days of use.

As members of the informal Company of Deep Canyon Creek Irrigation, with water right 13-53, We agree that the rightful division of shares is the same that has been historically used and shown in an 8 day rotation as follows:

Chatterton Lazy JC Ranch	3/8	3 days of 8	37.5%
G&G Properties	2/8	2 days of 8	25 %
Rallison Family	2/8	2 days of 8	25%
Jensen Family (Wanda)	1/8	1 day of 8	12.5%

Previous to 1981, the shares were the same between: CW Chatterton, Willard Gibson, Doug Oliverson, and Wanda Jensen.

In a previous meeting with you, Mr. Budge, and the members of this company, the majority of members agreed that this was the correct and accepted division of water shares.

Enclosed are copies of the records of the scheduling and maintenance costs of the Deep Canyon Creek water lines, and notarized signatures of members who agree with this Division.

The division of days & Repairs is for the 1981 (upper) irrigation system. When water is comm. fast at the first of the season, water is caught in a 2nd diversion & sent to the 1965? (Lower) irrigation system. Later - Late June or Early July - We go on turns and the water all comes through the top line.

As a member of the informal Deep Canyon Creek Irrigation Company, I agree that the division of shares and expenses have been as follows for more than fifty years:

Chatterton Lazy JC Ranch	3/8	or	37.5%
G & G Properties (previously Gibsons)	2/8	or	25 %
Rallison Family Trust (previously Oliversons)	2/8	or	25 %
Wanda Jensen &	1/8	or	12.5%
Representative Casey Jensen			

We also agree to all attachments and appendages.

DATE 2-24-2020

Chatterton Lazy JC Ranch  
By Steven B Chatterton

STATE OF IDAHO

County of Franklin

On the 24 day of Feb, 2020 personally appeared before me  
Steven B Chatterton, the signer of the within instrument, who duly acknowledged to me that she executed the same.



Christy Bartholome

NOTARY PUBLIC

Residing at: Preston

My Commission Expires:

11-26-22

As a member of the informal Deep Canyon Creek Irrigation Company, I agree that the division of shares and expenses have been as follows for more than fifty years:

Chatterton Lazy JC Ranch	3/8	or	37.5%
G & G Properties (previously Gibsons)	2/8	or	25 %
Rallison Family Trust (previously Oliversons)	2/8	or	25 %
Wanda Jensen &	1/8	or	12.5%
Representative Casey Jensen			

We also agree to all attachments and appendages.

DATE 3-9-20

*K. Olivera Ralbeson*

STATE OF IDAHO

County of Franklin

On the 9 day of March, 2020 personally appeared before me  
Susan Blair, the signer of the within instrument, who duly acknowledged to  
me that she executed the same.



*Susan Blair*

NOTARY PUBLIC

Residing at: Weston, ID

My Commission Expires:

12.07.21

As a member of the informal Deep Canyon Creek Irrigation Company, I agree that the division of shares and expenses have been as follows for more than fifty years:

Chatterton Lazy JC Ranch	3/8	or	37.5%
G & G Properties (previously Gibsons)	2/8	or	25 %
Rallison Family Trust (previously Oliversons)	2/8	or	25 %
Wanda Jensen &	1/8	or	12.5%

Representative Casey Jensen

We also agree to all attachments and appendages.

DATE 2-27-2020

Wanda G. Jensen

Casey Jensen

STATE OF IDAHO

County of Franklin

On the 27 day of February, 2020 personally appeared before me

Wanda Jensen, the signer of the within instrument, who duly acknowledged to me that she executed the same.



Tyona Atkinson

NOTARY PUBLIC

Residing at:

My Commission Expires:

10-9-2024



Water Right 13-53

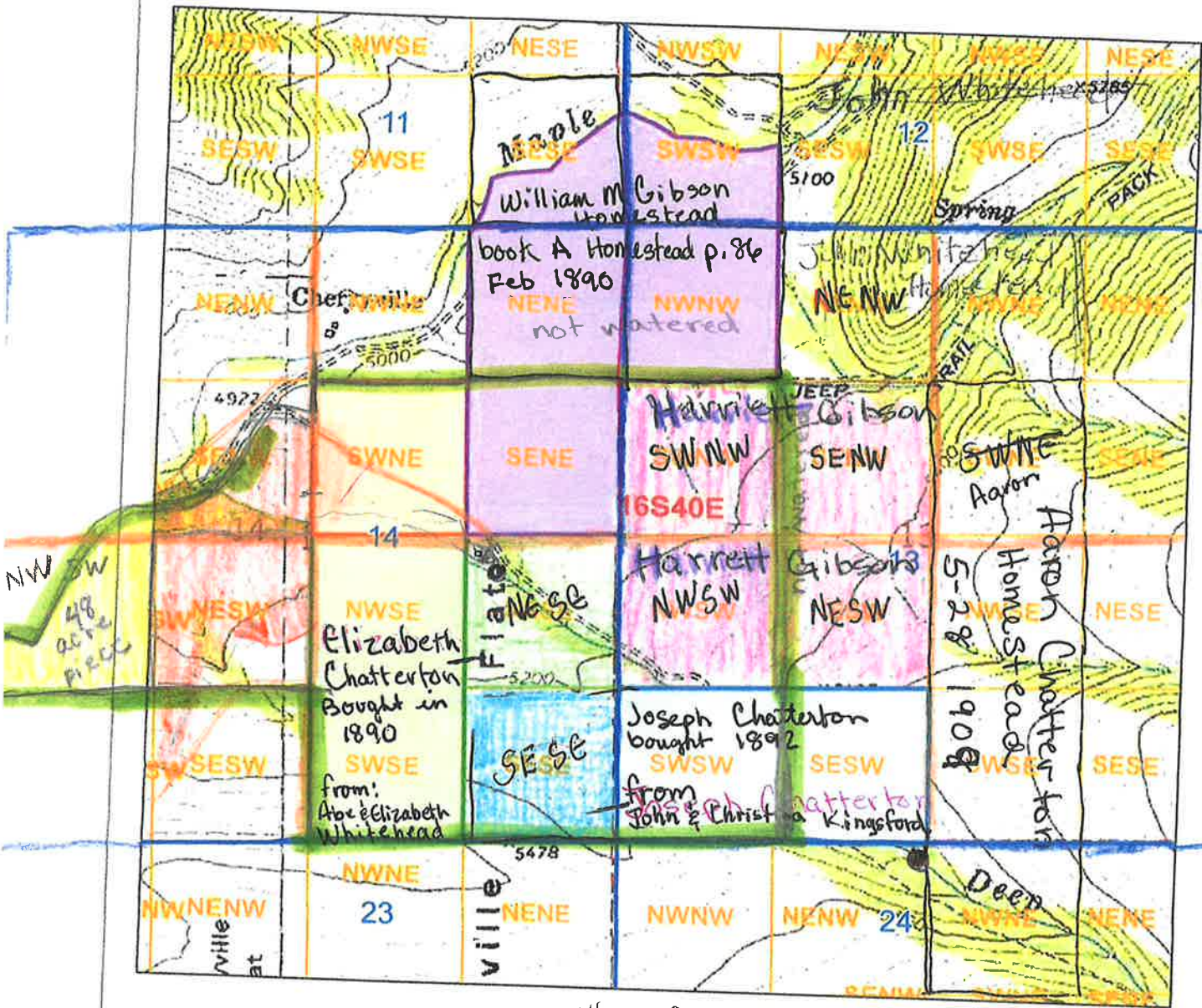

2013 Aerial Photo

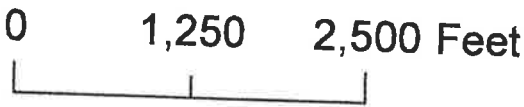
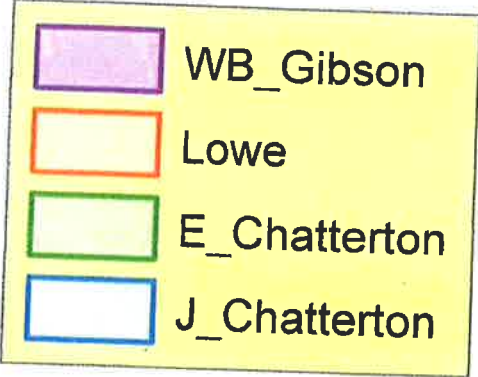

**Water Right**  
**13-53A**

The map depicts the place of use for the water use listed above and point(s) of diversion of this right as currently derived from interpretations of the paper records and is used solely for illustrative purposes. Discrepancies between the computer representation and the permanent document file will be resolved in favor of the actual water right documents in the water right file.

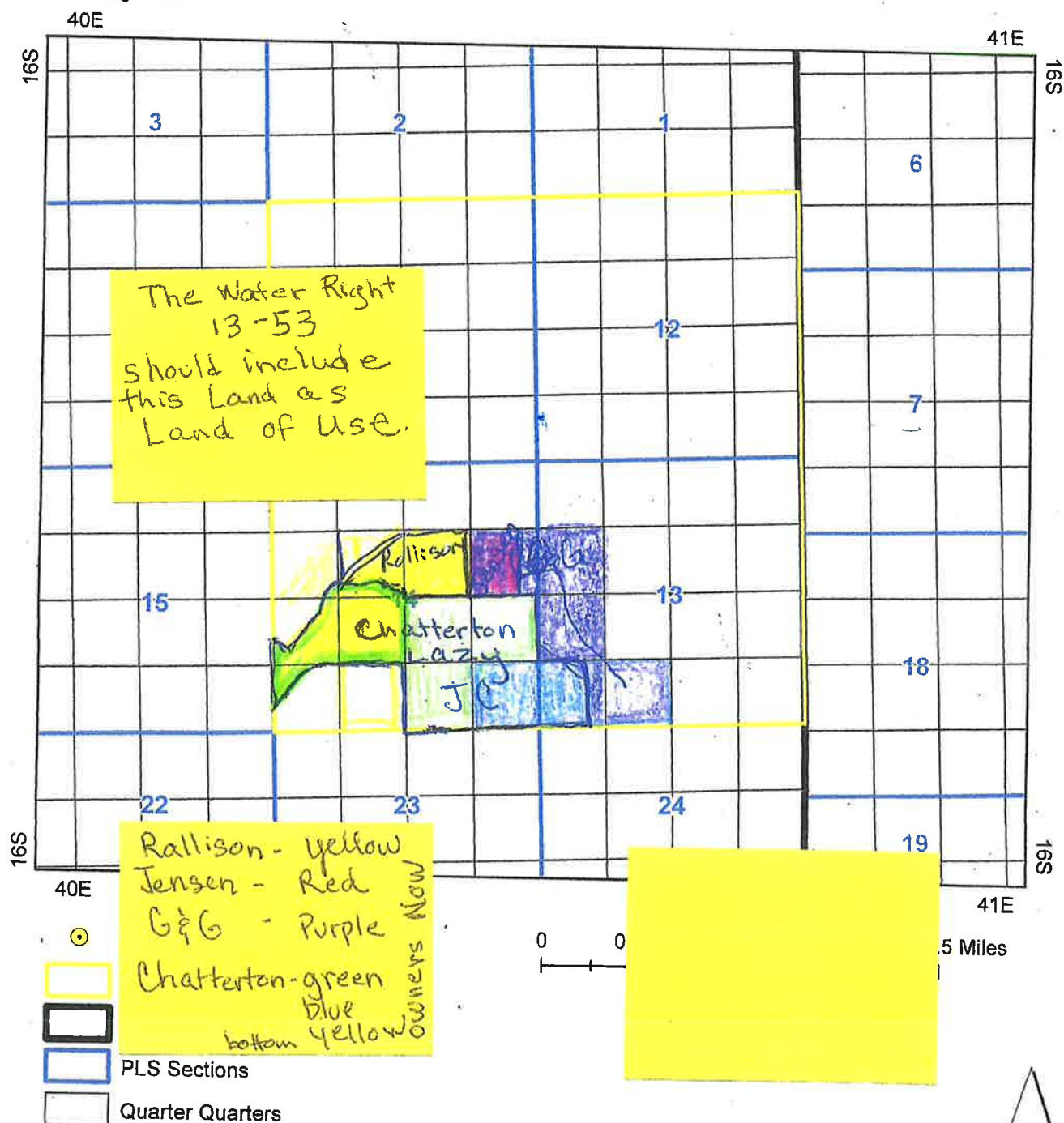



DEEP CREEK IRRIGATION WATER SCHEDULE.

<u>MAY</u>	<u>JUNE</u>	<u>JULY</u>	<u>AUGUST</u>
1 Rallison	1 Jensen	1 Chatterton	1 Chatterton
2 Rallison	2 Rallison	2 Chatterton	2 Chatterton
3 Silcock	3 Rallison	3 Jensen	3 Chatterton
4 Silcock	4 Silcock	4 Rallison	4 Jensen
5 Chatterton	5 Silcock	5 Rallison	5 Rallison
6 Chatterton	6 Chatterton	6 Silcock	6 Rallison
7 Chatterton	7 Chatterton	7 Silcock	7 Silcock
8 Jensen	8 Chatterton	8 Chatterton	8 Silcock
9 Rallison	9 Jensen	9 Chatterton	9 Chatterton
10 Rallison	10 Rallison	10 Chatterton	10 Chatterton
11 Silcock	11 Rallison	11 Jensen	11 Chatterton
12 Silcock	12 Silcock	12 Rallison	12 Jensen
13 Chatterton	13 Silcock	13 Rallison	13 Rallison
14 Chatterton	14 Chatterton	14 Silcock	14 Rallison
15 Chatterton	15 Chatterton	15 Silcock	15 Silcock
16 Jensen	16 Chatterton	16 Chatterton	16 Silcock
17 Rallison	17 Jensen	17 Chatterton	17 Chatterton
18 Rallison	18 Rallison	18 Chatterton	18 Chatterton
19 Silcock	19 Rallison	19 Jensen	19 Chatterton
20 Silcock	20 Silcock	20 Rallison	20 Jensen
21 Chatterton	21 Silcock	21 Rallison	21 Rallison
22 Chatterton	22 Chatterton	22 Silcock	22 Rallison
23 Chatterton	23 Chatterton	23 Silcock	23 Silcock
24 Jensen	24 Chatterton	24 Chatterton	24 Silcock
25 Rallison	25 Jensen	25 Chatterton	25 Chatterton
26 Rallison	26 Rallison	26 Chatterton	26 Chatterton
27 Silcock	27 Rallison	27 Jensen	27 Chatterton
28 Silcock	28 Silcock	28 Rallison	28 Jensen
29 Chatterton	29 Silcock	29 Rallison	29 Rallison
30 Chatterton	30 Chatterton	30 Silcock	30 Rallison
31 Chatterton		31 Silcock	31 Silcock

All water turns will start at 7:00 A.M.

Person or persons who are operating the farm that has a turn expiring will turn off all valves on that farm by 7:00 A. M.

50.08 1994

69.51

6.92

50.00

169.60

50.00

131.16

527.19

Jensen = 65.90

Rallison = 131.80

Gibson = 131.80

Chatterton = 197.78

527.28



DCI 1995

48.40+

97.44+

9.54+

9.20+

3.05+

10.10+

12.80+

148.15+

50.00+

9.54+

3.59+

8.59+

Parts

410.40 \*

••0••

25. x

12.5=

Labor

312.50

0.00 \*

312.50+

410.40+

Total

722.90 \*

722.9÷

8.=

Jensen

90.36

0.00 \*

90.36x

2.=

Rallison

180.72

0.00 \*

90.36x

5.=

Chatt

451.80

DCI 1996

31.29+  
130.26+  
30.13+  
37.13+  
56.33+  
38.70+  
25.00+  
50.00+  
50.00+  
456.84 \*

Parts

••0••

0.00+  
25.00=  
12.5=  
312.50

Labor

0.00 \*

312.50+  
456.84+  
769.34 \*

Total

••0••

769.34÷  
8.0=  
96.17

Jensen

96.17x  
2.0=  
192.34

Rallison

0.00 \*

••0••

96.17x  
5.0=  
480.85

Chatt.

0.00 \*

••0••

DCI 1997

38.40+  
195.47+  
55.00+  
143.26+  
21.75+  
92.31+  
546.19 \*

Parts

••0••

30.00x  
12.5=  
375.00

Labor

0.00 \*

••0••

375.00+  
546.19+  
921.19÷  
8.0=  
115.15

Total

Jensen

115.15x  
2.0=  
230.30

Rallison

••0••

115.15x  
2.0=  
230.30

Gibson

••0••

115.15x  
3.0=  
345.45

Chatt

DCI 1748

0.00 \*

0.00

30.47+

7.40+

135.29+

Parts

50.00+

225.16 \*

0.00

25.00

Labor

12.50

312.50

0.00 \*

0.00

312.50+

225.16+

Total

535.66 \*

535.66+

8.00

*of share* 66.95

66.95x

3.00

*Chatt* 200.85

0.00 \*

0.00

66.95x

2.00

*Gibson* 133.90

0.00 \*

0.00

66.95x

2.00

*Rallison* 133.90

0.00 \*

0.00

66.95x

1.00

*Jensen* 66.95

0.00 \*

0.00

DCI 1999

Pits 135.72+  
Spray 15.60+  
backhoe 50.00+  
Total 201.32 \*

••0••

25.00  
12.50  
Labor 312.50

••0••

201.32+  
312.50+  
Total 513.82 \*

513.82÷  
8.00=

~~1/8 shore~~ 64.23

64.23x  
3.00=

Chatt 192.69

••0••

64.23x  
2.00=

Gibson 128.46

••0••

64.23x  
2.00=

Rallison 128.46

••0••

64.23x  
1.00=

Jensen 64.23

2000 DCI

Backhoe 60.50+  
Pits 7.80+  
Spray 15.60+  
Total 83.90 \*

••0••

25.00  
12.50  
Labor 312.50

••0••

83.90+  
312.50+  
Total 396.40 \*

••0••

396.40÷  
8.00=

~~1/8~~ 49.55

49.55x

3.00=

Chatt 148.65

••0••

49.55x

2.00=

Gibson 99.10

••0••

49.55x

2.00=

Rallison 99.10

••0••

49.55x

1.00=

Jensen 49.55

0.00 \*

••0••



DCI 1999

Pnts 135.72+  
Spray 15.60+  
backhoe 50.00+  
Total 201.32 \*

••0••

25.0x  
12.5=  
Labor 312.50

••0••

201.32+  
312.50+  
Total 513.82 \*

513.82÷  
8.0=

~~1/8 Shore 64.23~~

64.23x  
3.0=

Chatt 192.69

••0••

64.23x  
2.0=

Gibson 128.46

••0••

64.23x  
2.0=

Rallison 128.46

••0••

64.23x  
1.0=

Jenson 64.23

2000 DCI

Backhoe 60.50+  
Pnts 7.80+  
Spray 15.60+  
Total 83.90 \*

••0••

25.0x  
12.5=  
Labor 312.50

••0••

83.90+  
312.50+  
Total 396.40 \*

••0••

396.4÷  
8.0=

~~1/8~~ 49.55

49.55x  
3.0=

Chatt 148.65

••0••

49.55x  
2.0=

Gibson 99.10

••0••

49.55x  
2.0=

Rallison 99.10

••0••

49.55x  
1.0=

Jenson 49.55

0.00 \*

••0••

2001

Pits & Backhoe  
Spray

418.51 ÷  
15.60 ÷  
434.11 \*

••0••

Labor

25. x  
12.5 =  
312.50

0.00 \*

••0••

Total

434.11 ÷  
312.50 ÷  
746.61 \*

1/8

746.61 ÷  
8. =  
93.33

0.00 \*

••0••

Chatt

93.33 x  
3. =  
279.99

0.00 \*

Rallison

93.33 x  
2. =  
186.66

0.00 \*

Gibson

93.33 x  
2. =  
186.66

0.00 \*

Jensen

93.33 x  
1. =  
93.33

"2002"

Pits & Backhoe  
Spray

261.06 ÷  
15.60 ÷  
276.66 \*

Labor

25. x  
12.5 =  
312.50

0.00 \*

Total

276.66 ÷  
312.66 ÷  
589.32 \*

1/8

589.32 ÷  
8. =  
73.67  
0.00 \*

Chatt

73.67 x  
3. =  
221.01

0.00 \*

Rallison

73.67 x  
2. =  
147.34

Gibson

73.67 x  
2. =  
147.34

Jensen

73.67 x  
1. =  
73.67  
0.00 \*

••0••

2003

Pits & Backhoe  
Spray

94.61 ÷  
15.60 ÷  
110.21 \*

Labor

25. x  
12.5 =  
312.50

0.00 \*

Total

110.21 ÷  
312.50 ÷  
422.71 \*

1/8

422.71 ÷  
8. =  
52.84  
0.00 \*

Chatt

52.84 x  
3. =  
158.52  
0.00 \*

Rallison

52.84 x  
2. =  
105.68  
0.00 \*

Gibson

52.84 x  
2. =  
105.68

Jensen

52.84 x  
1. =  
52.84  
0.00 \*

# Deep crk Irrigation 2004

5-4-04	Charged pipeline 2 hr.	90.00
5-12-04	Rebuilt screen - 3 hr.	135.00
	22 ft mesh	34.98
	1/2 box Self Tap Screws	10.00
5-12-04	Maintenance at hel. Box 3 hr.	135.00
5-27-04	Rpr. pipeline 6.5 hr	292.50
	Parts	38.90
	Tractor 1 hr	60.00
6-14-04	Rpr. pipeline 3.5 hr.	157.50
	Parts	27.78
	Tractor 1 hr	60.00
6-19-04	Rpr. pipeline 4 hr.	180.00
	Parts	77.36
	Tractor 1 hr	60.00
8-3-04	Rpr. Pipeline 3 1/2 hr.	157.50
	Parts	61.97
	Tractor 1 hr.	60.00
10-23-04	Drained pipeline 2.5 hr.	112.50
	Accounting for Summer 3 hr.	135.00
		<u>1885.99</u>
		1/4 238.75

## Deep Creek Irrigation 2004

Total \$1886.00

1/8 Share \$235.75

Silcock Share 471.50

This does not take into accounting  
the daily maintenance of headbox  
and Screen and adjusting Valve.  
At the very minimum this requires  
a half hour to an hour daily.



~~127349~~

1886

Silcock

471.50

Rallison

471.50

Penner

235.25

Chatt

707.25

DEEP CREEK IRRIGATION WATER SCHEDULE

<u>MAY</u>	<u>JUNE</u>	<u>JULY</u>	<u>AUGUST</u>
1 Rallison	1 Jensen	1 Chatterton	1 Chatterton
2 Rallison	2 Rallison	2 Chatterton	2 Chatterton
3 Silcock	3 Rallison	3 Jensen	3 Chatterton
4 Silcock	4 Silcock	4 Rallison	4 Jensen
5 Chatterton	5 Silcock	5 Rallison	5 Rallison
6 Chatterton	6 Chatterton	6 Silcock	6 Rallison
7 Chatterton	7 Chatterton	7 Silcock	7 Silcock
8 Jensen	8 Chatterton	8 Chatterton	8 Silcock
9 Rallison	9 Jensen	9 Chatterton	9 Chatterton
10 Rallison	10 Rallison	10 Chatterton	10 Chatterton
11 Silcock	11 Rallison	11 Jensen	11 Chatterton
12 Silcock	12 Silcock	12 Rallison	12 Jensen
13 Chatterton	13 Silcock	13 Rallison	13 Rallison
14 Chatterton	14 Chatterton	14 Silcock	14 Rallison
15 Chatterton	15 Chatterton	15 Silcock	15 Silcock
16 Jensen	16 Chatterton	16 Chatterton	16 Silcock
17 Rallison	17 Jensen	17 Chatterton	17 Chatterton
18 Rallison	18 Rallison	18 Chatterton	18 Chatterton
19 Silcock	19 Rallison	19 Jensen	19 Chatterton
20 Silcock	20 Silcock	20 Rallison	20 Jensen
21 Chatterton	21 Silcock	21 Rallison	21 Rallison
22 Chatterton	22 Chatterton	22 Silcock	22 Rallison
23 Chatterton	23 Chatterton	23 Silcock	23 Silcock
24 Jensen	24 Chatterton	24 Chatterton	24 Silcock
25 Rallison	25 Jensen	25 Chatterton	25 Chatterton
26 Rallison	26 Rallison	26 Chatterton	26 Chatterton
27 Silcock	27 Rallison	27 Jensen	27 Chatterton
28 Silcock	28 Silcock	28 Rallison	28 Jensen
29 Chatterton	29 Silcock	29 Rallison	29 Rallison
30 Chatterton	30 Chatterton	30 Silcock	30 Rallison
31 Chatterton		31 Silcock	31 Silcock

All water turns will start at 7:00 A.M.

Person or persons who are operating the farm that has a turn expiring will turn off all valves on that farm by 7:00 A. M.

Steven B Chatterton  
5203 Maple Creek Road  
Franklin, ID 83237

March 16, 2005

Robert Silcock  
P.O. Box 1292  
Burley, ID 83318

Dear Robert Silcock:

The purpose of this letter is to demand payment of money owed regarding your Open Account.

On October 26, 2004, you incurred charges to your Open Account with me by purchasing Water dues for Deep Creek Irrigation. The current balance of this account is \$471.50.

In addition, on December 01, 2004, interest began to accrue at a rate of 21.00% per annum. As of March 16, 2005 the accrued interest you owe equals \$28.48.

You are now past due in making payment. Demand is made upon you for full payment of the following amount:

Principal Balance	\$471.50
Accrued Interest	\$28.48
<i>Total</i>	\$499.98

If payment is not made by April 11, 2005, legal action to enforce your obligations under the Open Account Agreement may be taken. Please give this matter your prompt attention.

You may contact me at the above address if you have any questions or need additional information. I can be contacted via e-mail at [dustyrdchatt@lds.net](mailto:dustyrdchatt@lds.net).

Sincerely,



Steven B Chatterton

Yes Mr. Silcock, an irrigation company was formed back in the eighteen hundreds by a group of men through verbal agreement and a hand shake. A handshake and a mans word is his seal and means much much more than all the signatures he could pen in a lifetime. For informational purpose only, I operate eleven farms with verbal contracts only and it works very well. As for the water in Deep Creek it is already filed on by the Maple Creek Irrigation Company. All we have are high water rights as is the case with every creek passing through your property. The only stream that flows year around (excluding the three culinary lines) through your property is Maple Creek in which you have no rights. The rest of the ditches and drains are for irrigation purposes and spring runoff only.

Later on, even before Dean Gibson, The Rallisons, or the younger Jensen boys were involved a pipeline was installed. The pipeline was put in because the water in Deep Creek sank a little below the upper tank. If it was ever proved that it reached Maple Creek underground then we would have to give it up.

Yes installing the pipeline was left up to the Chattertons to install hence has been left up to us to maintain throughout the years. As far as agreeing to pay maintenance costs that was implied when you opened the valve to use the water.

As for "calling the shots" that must be a term the big boys in the city use. Around here we call it pitching in and making things go and work for the benefit of all. That attribute was bred in from a long line of a heritage of men and women with forthright spirits and integrity of a magnitude of which you or I will never attain in this life. There is much higher law than the one that you are using to push around your ego. So if you feel the need to "call the shots" then come on down. But with that mantle also assume the charge and responsibility to deliver water to the rest of the share holders in a constant, timely and fair manner.

The bills and monthly accounts have been paid through my farm checking account and returned to my checking account when reimbursed in the fall. The Jensens paid \$235.75 on 11-03-2004 and the Rallisons paid \$471.50 on 11-15-2004. You may verify this with Randy Jensen (phone # 435-258-2672) and David or Doug Rallison ( 208-646-0906).

So whether are not you choose to pay this bill is up to you. My responsibility is to give you the opportunity to pay your debts in this life. You have the agency to act upon it or not.

Enclosed you will find another copy of last years maintenance and repairs and shareholders costs. Also a copy containing the water schedule for your renters of which they abused last year.



# Deep Creek Irrigation

5-31-2006

5-17-2006 Repair

Irrigation Aid ~~160.49~~  
 KCA Escavating  
 KCA Escavating  
 3 hour w/ 1/2 tractor  
 Chatterton Lazy JT Ranch Labor 2hr. 120.00  
 100.00  
 98.00  
 160.49

5-27-2006 Repair

Irrigation Aid  
 Chatterton Lazy JT Ranch Labor 2hr.

24.81  
 20.00  
 44.81

Irrigation Aid Parts 185.30  
 Silcock Share - 46.33  
 Rallison Share - 46.33  
 Jensen Share - 23.16  
 Chatterton Share - 69.48

Make Check payable to Irrigation Aid

Chatterton Input  
 Silcock Share - 99.50  
 Rallison Share - 99.50  
 Jensen Share - 49.75  
 Chatterton Share - 149.25

Make Check payable to Chatterton Lazy JT Ranch

Review: Maud's  
 Hug

DeepCreek Irrigation

11/20/2006

Inv. Date

10/27/2006

11/16/2006

Total

1/8 share

Irrigation Aid

\$84.06 Inv.# 12955

\$684.76 Inv.# 13081

\$768.82

\$96.10

\$288.31 Chatt Share

\$192.21 Rallison Share

\$192.21 Silcock Share

\$96.10 Jensen Share

**Make check payable to Irrigation Aid**Chatterton Input

10/27/2006 Backhoe

\$150.00

11/16/2006 Backhoe

\$150.00

10/27/2006 man hrs

\$125.00

11/16/2006 man hrs

\$275.00

Total

\$700.00

1/8 share

\$87.50

\$262.50 Chatt share

\$175.00 Rallison Share

\$175.00 Silcock Share

\$87.50 Jensen Share

*@ 75.00 per hr.**@ 25.00 per hr. per man*

DEEP CREEK IRRIGATION REPAIR

Date Sent

6/23/2007

23

← Error made on  
Date

MAY

2007

	<u>PARTS</u>	<u>SHARE of Parts</u>	<u>LABOR</u>	<u>SHARE of Labor</u>
5/10/2007	\$32.72	\$4.09	\$120.00	\$15.00
5/11/2007	\$61.66	\$7.71	\$180.00	\$22.50
5/14/2007	\$41.37	\$5.17	\$180.00	\$22.50
6/4/2007	<u>\$34.68</u>	<u>\$4.34</u>	<u>\$180.00</u>	<u>\$22.50</u>
Total	\$170.43	\$21.30	\$660.00	\$82.50

Jensen owes Irrigation Aid \$21.30  
Jensen owes Chatterton \$82.50

Rallison owes Irrigation Aid \$42.61  
Rallison owes Chatterton \$165.00

Silcock owes Irrigation Aid \$42.61  
Silcock Owes Chatterton \$165.00

Chatterton owes Irrigation Aid \$63.91  
Chatterton owes Chatterton \$247.50

Pd. 6-26-07

pd. 6-23-07

**DEEP CREEK IRRIGATION REPAIR****Date Sent**  
6/10/2008**May****2008**

	<u>PARTS</u>	<u>SHARE of Parts</u>	<u>LABOR</u>	<u>SHARE of Labor</u>
5/19/2008	\$88.88	\$11.11	\$100.00	\$12.50
5/20/2008	\$12.06	\$1.51	\$100.00	\$12.50
	\$0.00	\$0.00	\$0.00	\$0.00
	<u>\$0.00</u>	<u>\$0.00</u>	<u>\$0.00</u>	<u>\$0.00</u>
Total	\$100.94	\$12.62	\$200.00	\$25.00

Jensen owes Irrigation Aid \$12.62  
Jensen owes Chatterton \$25.00

Rallison owes Irrigation Aid \$25.24  
Rallison owes Chatterton \$50.00

*see attached*  
Silcock owes Irrigation Aid \$25.24  
Silcock Ows Chatterton \$50.00

Chatterton owes Irrigation Aid \$37.85  
Chatterton owes Chatterton \$75.00

ck # 1216 7/8/08

ck # 1217 7/8/08



**DEEP CREEK IRRIGATION REPAIR****Date Sent**

7/13/2008

**June****2008**

	<b><u>PARTS</u></b>	<b><u>SHARE of Parts</u></b>	<b><u>LABOR</u></b>	<b><u>SHARE of Labor</u></b>	<b><u>M.DALEY</u></b>	<b><u>Share of M. DALEY</u></b>
6/14/2008	\$285.42	\$35.68	\$340.00	\$42.50	\$0.00	\$0.00
6/17/2008	\$222.26	\$27.78	\$75.00	\$9.38	\$0.00	\$0.00
6/27/2008	\$29.01	\$3.63	\$0.00	\$0.00	\$190.00	\$23.75
	<u>\$0.00</u>	<u>\$0.00</u>	<u>\$0.00</u>	<u>\$0.00</u>	<u>\$0.00</u>	<u>\$0.00</u>
Total	\$536.69	\$67.09	\$415.00	\$51.88	\$190.00	\$23.75

Jensen owes Irrigation Aid	\$67.09
Jensen owes Chatterton	\$51.88
Jensen owes Mike Daley	\$23.75

Rallison owes Irrigation Aid	\$134.17
Rallison owes Chatterton	\$103.75
Rallison owes Mike Daley	\$47.50

Silcock owes Irrigation Aid	\$134.17
Silcock Owes Chatterton	\$103.75
Silcock owes Mike Daley	\$47.50

Chatterton owes Irrigation Aid	\$201.26
Chatterton owes Chatterton	\$155.63
Chatterton owes Mike Daley	\$71.25

**DEEP CREEK IRRIGATION REPAIR****Date Sent**  
8/30/2008**July**                      **2008**

	<b><u>PARTS</u></b>	<b><u>SHARE of Parts</u></b>	<b><u>LABOR</u></b>	<b><u>SHARE of Labor</u></b>	<b><u>M.DALEY</u></b>	<b><u>Share of M. DALEY</u></b>
7/8/2008	\$42.44	\$5.31	\$100.00	\$12.50	\$0.00	\$0.00
	\$0.00	\$0.00		\$0.00	\$0.00	\$0.00
	\$0.00	\$0.00	\$0.00	\$0.00		\$0.00
	<u>\$0.00</u>	<u>\$0.00</u>	<u>\$0.00</u>	<u>\$0.00</u>	<u>\$0.00</u>	<u>\$0.00</u>
Total	\$42.44	\$5.31	\$100.00	\$12.50	\$0.00	\$0.00

Jensen owes Irrigation Aid                      \$5.31  
Jensen owes Chatterton                      \$12.50  
Jensen owes Mike Daley                      \$0.00

Rallison owes Irrigation Aid                      \$10.61  
Rallison owes Chatterton                      \$25.00  
Rallison owes Mike Daley                      \$0.00

Silcock owes Irrigation Aid                      \$10.61  
Silcock Owes Chatterton                      \$25.00  
Silcock owes Mike Daley                      \$0.00

ck # 1235 \$25.00  
Chatterton  
9/4/08

Chatterton owes Irrigation Aid                      \$15.92  
Chatterton owes Chatterton                      \$37.50  
Chatterton owes Mike Daley                      \$0.00

**DeepCreek Irrigation**

11/13/2009

**Inv. Date**

**Irrigation Aid**

5/12/2009 \$31.31 Inv.#11532  
6/22/2009 \$151.52 Inv.# 12353  
Total \$182.83

1/8 share \$22.85

\$68.56 Chatt Share  
\$45.71 Rallison Share  
\$45.71 Silcock Share  
\$22.85 Jensen Share

payable to Chatterton Lazy JC Ranch

**Chatterton Input**

5/12/2009 Bkh,Labor \$100.00  
6/22/2009 Bkh,labor \$200.00

Total \$300.00

1/8 share \$37.50

\$112.50 Chatt share  
\$75.00 Rallison Share  
\$75.00 Silcock Share  
\$37.50 Jensen Share

payable to Chattertons Lazy JC Ranch

Rallison Share \$120.71  
Silcock Share \$120.71  
Jensen Share \$60.35  
Chatt Share \$181.06

**Pay Chatterton Lazy JC Ranch**  
5203 Maple Creek Road  
Franklin, ID 83237

DeepCreek Irrigation

11/16/2010

Inv. Date

Irrigation A/c

4/27/2010	\$8.13 Inv.#3574C
6/1/2010	\$5.36 Inv.# 57011
6/17/2010	\$87.11 Inv.#63098
6/25/2010	\$82.54 Inv.#57541
7/2/2010	<u>\$67.58</u> Inv.57763
Total	\$250.72

1/8 share \$31.34

\$94.02 Chatt Share  
\$62.68 Rallison Share  
\$62.68 Silcock Share  
\$31.34 Jensen Share

payable to Chatterton Lazy JC Ranch

Chatterton Input

11/16/2010 Labor	\$390.00
6/22/2009 Backhoe	<u>\$300.00</u>

Total \$690.00

1/8 share \$86.25

\$258.75 Chatt share  
\$172.50 Rallison Share  
\$172.50 Silcock Share  
\$86.25 Jensen Share

payable to Chattertons Lazy JC Ranch

Rallison Share	\$235.18
Silcock Share	\$235.18
Jensen Share	\$117.59
Chatt Share	\$352.77

**Pay Chatterton Lazy JC Ranch**  
5203 Maple Creek Road  
Franklin, ID 83237

**DEEP CREEK IRRIGATION REPAIR****Date Sent**

12/14/2011

July2008

	<b><u>PARTS</u></b>	<b><u>SHARE of Parts</u></b>	<b><u>LABOR</u></b>	<b><u>SHARE of Labor</u></b>	<b><u>M.DALEY</u></b>	<b><u>Share of M. DALEY</u></b>
6/4/2011	\$23.80	\$2.98	\$100.00	\$12.50	\$0.00	\$0.00
6/28/2011	\$215.78	\$26.97	\$100.00	\$12.50	\$0.00	\$0.00
7/18/2011	\$20.93	\$2.62	\$80.00	\$10.00		\$0.00
8/2/2011	\$9.36	\$1.17	\$50.00	\$6.25		
2011 pipe i maintenance	\$0.00	\$0.00	\$400.00	\$50.00	\$0.00	\$0.00
Total	\$269.87	\$33.73	\$730.00	\$91.25	\$0.00	\$0.00

Jensen owes Irrigation Aid

Jensen owes Chatterton

Jensen owes Mike Daley

\$124.98

Rallison owes Irrigation Aid

Rallison owes Chatterton

Rallison owes Mike Daley

\$249.97

Silcock owes Irrigation Aid

Silcock Owes Chatterton

Silcock owes Mike Daley

\$249.97

Chatterton owes Irrigation Aid

Chatterton owes Chatterton

Chatterton owes Mike Daley

\$374.95

**Statement For 2012**

**DeepCreek Irrigation**

4/7/2013

**Inv. Date**  
5/9/2012

**Irrigation Aid**  
\$2.50 Inv62161

Total - \$2.50

1/8 share \$0.31

\$0.94 Chatt Share  
\$0.63 Rallison Share  
\$0.63 Silcock Share  
\$0.31 Jensen Share

**payable to Chatterton Lazy JC Ranch**

**Chatterton Input**

2012

Labor & Fuel - \$400.00

Total - \$400.00

1/8 share \$50.00

\$150.00 Chatt share  
\$100.00 Rallison Share  
\$100.00 Silcock Share  
\$50.00 Jensen Share

**payable to Chattertons Lazy JC Ranch**

Rallison Share \$100.63  
Silcock Share \$100.63  
Jensen Share \$50.31  
Chatt Share \$150.94

**Pay Chatterton Lazy JC Ranch**  
5203 Maple Creek Road  
Franklin, ID 83237



**Statement For 2013**

**DeepCreek Irrigation**

12/19/2013

**Inv. Date**

4/30/2013

5/2/2013

**Irrigation Aid**

\$14.57 Inv 82863

\$4.19 inv 86145

Total        -        \$18.76

1/8 share        \$2.35

\$7.04 Chatt Share

\$4.69 Rallison Share

\$4.69 Silcock Share

\$2.35 Jensen Share

**payable to Chatterton Lazy JC Ranch**

**Chatterton Input**

2013

Labor &        \$400.00  
Fuel        -

Total        -        \$400.00

1/8 share        \$50.00

\$150.00 Chatt share

\$100.00 Rallison Share

\$100.00 Silcock Share

\$50.00 Jensen Share

**payable to Chattertons Lazy JC Ranch**

Rallison Share        \$104.69

Silcock Share        \$104.69

Jensen Share        \$52.35

Chatt Share        \$157.04

**Pay Chatterton Lazy JC Ranch**

5203 Maple Creek Road

Franklin, ID 83237

**Statement for 2014**

**DeepCreek Irrigation**

12/19/2013

**Inv. Date**

3/24/2014

4/25/2014

**Irrigation Aid**

\$54.38 Inv.67188

\$22.05 Inv.67433

Total \$76.43

1/8 share \$9.55

\$28.66 Chatt Share

\$19.11 Rallison Share

\$19.11 Silcock Share

\$9.55 Jensen Share

**payable to Chatterton Lazy JC Ranch**

**Chatterton Input**

2014

Labor & Fuel \$400.00

Total \$400.00

1/8 share \$50.00

\$150.00 Chatt share

\$100.00 Rallison Share

\$100.00 Silcock Share

\$50.00 Jensen Share

**payable to Chattertons Lazy JC Ranch**

Rallison Share \$119.11

Silcock Share \$119.11

Jensen Share \$59.55

Chatt Share \$178.66

**Pay Chatterton Lazy JC Ranch**

5203 Maple Creek Road

Franklin, ID 83237

# **Statement for 2015**

## **DeepCreek Irrigation**

9/16/2015

### **Inv. Date**

### **Irrigation Aid**

2/23/2015	\$22.05 Inv.69616
3/19/2015	\$134.32 Inv.69674
4/11/2015	\$72.63 Inv.29051
4/13/2015	\$139.72 inv.69781
4/13/2015	\$135.00 inv.69789
4/14/2015	\$54.00 inv.69794
4/14/2015	\$10.00 inv.69795
4/30/2015	\$201.40 inv.69986
5/11/2015	\$68.40 inv.70203
5/12/2015	\$127.87 inv.70230
5/13/2015	\$76.37 inv.70231

Total \$1,041.76

1/8 share \$130.22

\$390.66 Chatt Share  
\$260.44 Rallison Share  
\$260.44 Silcock Share  
\$130.22 Jensen Share

**payable to Chatterton Lazy JC Ranch**

## **Chatterton Input**

2015 Labor & Fuel \$600.00

Total \$600.00

1/8 share \$75.00

\$225.00 Chatt share  
\$150.00 Rallison Share  
\$150.00 Silcock Share  
\$75.00 Jensen Share

**payable to Chattertons Lazy JC Ranch**

Rallison Share	\$410.44
Silcock Share	\$410.44
Jensen Share	\$205.22
Chatt Share	\$615.66

**Pay Chatterton Lazy JC Ranch**  
5203 Maple Creek Road  
Franklin, ID 83237

**Statement for 2016**

**DeepCreek Irrigation**

11/1/2016

**Inv. Date**

**Irrigation Aid**

7/18/2016	\$61.00
10/28/2016	\$3.75
Total	\$64.75

1/8 share \$8.09

\$24.28 Chatt Share  
\$16.19 Rallison Share  
\$16.19 Silcock Share  
\$8.09 Jensen Share

**payable to Chatterton Lazy JC Ranch**

**Chatterton Input**

2016 Labor & Fuel \$500.00

7/18/2016 trackhoe \$100.00

10/28/2016 fixed riser broke by silcocks renters cows \$50.00

Total \$650.00

1/8 share \$81.25

\$243.75 Chatt share  
\$162.50 Rallison Share  
\$162.50 Silcock Share  
\$81.25 Jensen Share

**payable to Chattertons Lazy JC Ranch**

Rallison Share	\$178.69
Silcock Share	\$178.69
Jensen Share	\$89.34
Chatt Share	\$268.03

**Pay Chatterton Lazy JC Ranch**  
5203 Maple Creek Road  
Franklin, ID 83237

# Statement for 2017

## DeepCreek Irrigation

11/1/2017

### Inv. Date

### Irrigation Aid

5/22/2017	\$69.69
5/30/2017	\$80.97
7/31/2017	\$45.15
10/24/2017	\$70.62
Total	\$266.43

1/8 share \$33.30

\$99.91 Chatt Share  
\$66.61 Rallison Share  
\$66.61 Silcock Share  
\$33.30 Jensen Share

payable to Chatterton Lazy JC Ranch

## Chatterton Input

2017 Labor & Fuel \$500.00

Dug 3 rpr with tractor \$300.00

Labor for three rprs \$100.00

Total \$900.00

1/8 share \$112.50

\$337.50 Chatt share  
\$225.00 Rallison Share  
\$225.00 Silcock Share  
\$112.50 Jensen Share

payable to Chattertons Lazy JC Ranch

Rallison Share	\$281.61
Silcock Share	\$291.61
Jensen Share	\$145.80
Chatt Share	\$437.41

**Pay Chatterton Lazy JC Ranch**  
5203 Maple Creek Road  
Franklin, ID 83237

**Statement for 2018**

**DeepCreek Irrigation**

10/24/2018

**Inv. Date**  
6/27/2018

**Valley Implement**  
\$371.95

Total \$371.95

1/8 share \$46.49

\$139.48 Chatt Share  
\$92.99 Rallison Share  
\$92.99 Arnell Share  
\$46.49 Jensen Share

**payable to Chatterton Lazy JC Ranch**

**Chatterton Input**

2018 Labor & Fuel \$500.00

Use Mike Daley trackhoe \$100.00

Labor for rpr \$100.00

Total \$700.00

1/8 share \$87.50

\$262.50 Chatt share  
\$175.00 Rallison Share  
\$175.00 Arnell Share  
\$87.50 Jensen Share

**payable to Chattertons Lazy JC Ranch**

Rallison Share \$267.99  
Arnell Share \$267.99  
Jensen Share \$133.99  
Chatt Share \$401.98

**Pay Chatterton Lazy JC Ranch**  
5203 Maple Creek Road  
Franklin, ID 83237

**Statement for 2019**

**DeepCreek Irrigation**

12/19/2019

**Inv. Date**

**Valley Implement**

7/18/2019

\$196.99

8/3/2019

\$86.46

-

Total           \$283.45

1/8 share       \$35.43

\$106.29 Chatt Share  
\$70.86 Rallison Share  
\$70.86 Arnell Share  
\$35.43 Jensen Share

**payable to Chatterton Lazy JC Ranch**

**Chatterton Input**

2019 Labor &  
Fuel

\$500.00

-

Labor for rpr

\$200.00

Total           \$700.00

1/8 share       \$87.50

\$262.50 Chatt share  
\$175.00 Rallison Share  
\$175.00 Arnell Share  
\$87.50 Jensen Share

**payable to Chattertons Lazy JC Ranch**

Rallison Share       \$245.86  
Arnell Share       \$245.86  
Jensen Share       \$122.93  
Chatt Share       \$368.79

**Pay Chatterton Lazy JC Ranch**  
5203 Maple Creek Road  
Franklin, ID 83237