

RECEIVED

AUG 16 2021

STATE OF IDAHO
DEPARTMENT OF WATER RESOURCES

WATER SUPPLY BANK RENTAL AGREEMENT No. 541

DEPARTMENT OF
WATER RESOURCES

This is to certify that:

WG FARMS LLC
WLR LC
695 N 700 E
RUPERT, ID 83350-8407

filed an application to rent water from the Water Supply Bank ("Bank"). The Idaho Water Resource Board ("Board"), being authorized to operate a Bank and to contract by and through the Director of the Idaho Department of Water Resources ("Director, Department") for rental of water from the Bank, agrees to rent water as follows:

Summary of Water Rights or Portions Rented from the Bank

Water Right No.	Priority Date	Source	Diversion Rate (CFS)	Diversion Volume (AF)	Acres (AC)	Rate Per Acre (CFS/AC)	Volume Per Acre (AF/AC)
43-13597	5/23/1962	GROUND WATER	0.48	309	77.3	0.006	4.0
43-13595	5/4/1978	GROUND WATER	2.65	641	160.3	0.02	4.0
Combined Rental Totals			2.65	950	160.3	0.01	4.0

Term of Rental: This rental agreement shall take effect when all parties have signed it and shall continue in effect until December 31, 2021. Use of rental water shall be authorized as of either the date this rental agreement takes effect or the first day of the rental season of use, in 2021, whichever occurs last.

Annual Rental Fee:

2021: \$19,018.00

The full fee for the rental of the above-described right(s) is \$19,018.00 for 2021. The rental fee includes an administrative fee of \$1,901.80 for 2021.

Total Water Use Authorized Under Rental Agreement

Beneficial Use	Diversion Rate (CFS)	Diversion Volume (AF)	Acres (AC)
MITIGATION BY NON-USE	2.65	713	Not Stated
Combined Total	2.65	713	Not Stated

** The authorized water usage reflects a reduction from the water right elements rented, to account for a change in the nature of use of the water right*

Detailed water right conditions are attached.

STATE OF IDAHO
DEPARTMENT OF WATER RESOURCES

WATER SUPPLY BANK RENTAL AGREEMENT No. 541

The undersigned renter agrees to use the water rented under this agreement in accordance with the Water Supply Bank rules and in compliance with the limitations and conditions of use described in this agreement:



Signature of Renter

8-9-21

Date

Derck Whitesides

Printed Name

Manager

Title

*Title required if signing on behalf of a company or organization or with power of attorney

Having determined that this agreement satisfied the provisions of Idaho Code § 42-1763 and IDAPA 37.02.03.030 (Water Supply Bank Rule 30), for the rental and use of water under the terms and condition herein provided, and none other, I hereby execute this Rental Agreement on behalf of the Idaho Water Resource Board.

By 

BRIAN PATTON, Acting Administrator
Idaho Water Resource Board

Date 9/9/21

Rental approved by IDWR 

Date 9/9/21

STATE OF IDAHO
DEPARTMENT OF WATER RESOURCES

WATER SUPPLY BANK RENTAL AGREEMENT No. 541

WATER USE DETAILS

LOCATION OF POINT(S) OF DIVERSION

The volume authorized under this rental will remain undiverted

BENEFICIAL USE

MITIGATION BY NON-USE

DIVERSION RATE

2.65 CFS

VOLUME

713 AF

SEASON OF USE

From To
4/15 10/31

RENTERS PLACE OF USE: MITIGATION BY NON-USE

Twp	Rng	Sec	NE				NW				SW				SE				Totals	
			NE	NW	SW	SE	NE	NW	SW	SE	NE	NW	SW	SE	NE	NW	SW	SE		
07S	22E	25	X	X	X	X	X	X	X	X	X	X	X	X	X	X	X	X	X	X

Total Acres: X

RENTAL AGREEMENT CONDITIONS OF ACCEPTANCE

- The use of water under this agreement shall be subject to the provisions of Idaho Code § 42-1766.
- Rental of the specified right from the bank does not, in itself, confirm the validity of the right or any elements of the water right, or improve the status of the right including the notion of resumption of use. It does not preclude the opportunity for review of the validity of this water right in any other department application process.
- Use of water under this agreement does not constitute a dedication of the water to renter's place of use, and upon expiration of this agreement, the points of diversion and place of use of the water shall revert to those authorized under the water right and/or again be available to rent from the bank.
- Use of water under this agreement shall not prejudice any action of the Department in its consideration of an application for transfer or permit filed by the applicant for this same use.
- Renter agrees to comply with all applicable state and federal laws while using water under this agreement.
- Renter agrees to hold the Board, the Director and the state of Idaho harmless from all liability on account of negligent acts of the renter while using water.
- Renter acknowledges and agrees that the Director may terminate authorization for the use of a water right based on a water right's priority date.
- Failure of the renter to comply with the conditions of this agreement is cause for the Director to rescind approval of the rental agreement.
- Use of water under this right may be regulated by a watermaster with responsibility for the distribution of water among appropriators within a water district. At the time of this approval, this water right is within State Water District No. 130.
- This agreement is not an authorization for the described effort to be used as mitigation or credit for any other purpose. The sufficiency of the non-use authorized under this right for mitigation or credit for some other purpose may be determined by the Department upon proper submission of a mitigation plan pursuant to the Department's Rules of Conjunctive Management of Surface and Ground Water Resources, a mitigation plan to offset depletion in association with a water right application, a Management Program pursuant to Idaho Code Idaho Code § 42-1416B, or any other proposal to utilize credit.

Idaho Water Resource Board

Attachment to Water Supply Bank Rental Agreement No. 541

Effective until December 31, 2021

This map depicts the rental place of use pursuant to the rental agreement and is attached to the agreement solely for illustrative purposes.

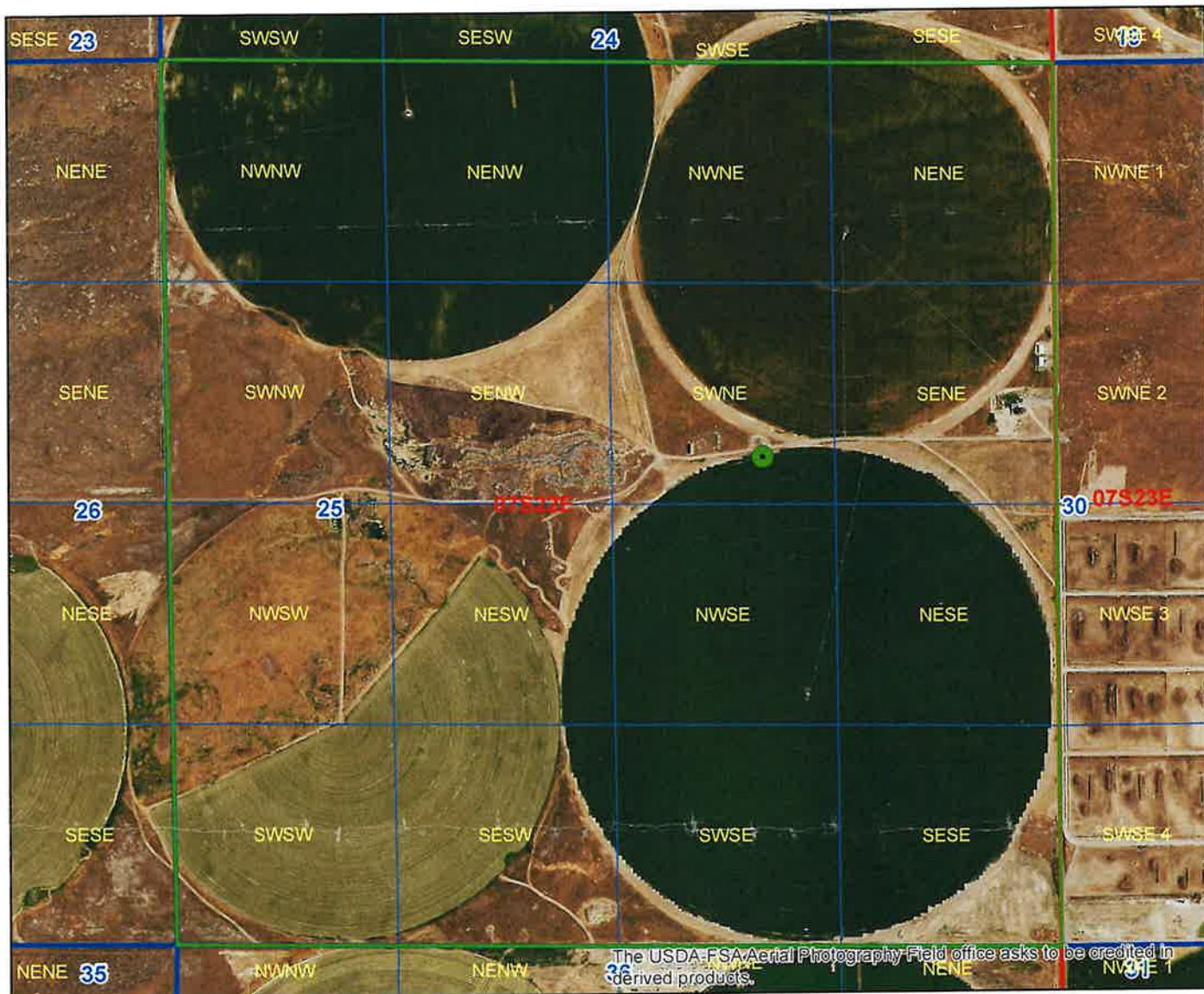

The USDA-FSA Aerial Photography Field office asks to be credited in derived products.

- Authorized Rental Point of Diversion
- Authorized Rental Place of Use
- Township/Range
- Sections
- QQ

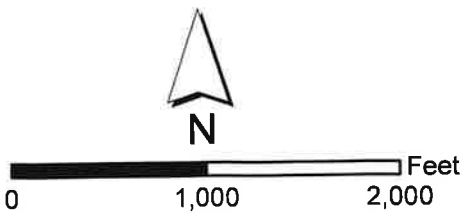

STATE OF IDAHO
WATER RESOURCE BOARD

RECEIVED

MAR 31 2021

DEPT OF WATER RESOURCES

APPLICATION TO RENT WATER
FROM THE BOARD'S WATER SUPPLY BANK

Applicant Name: WG Farms LLC, and WLR LC

Is this application being submitted with a lease application as a lease/rental package? Yes No

If yes, specify companion water rights in Section 4

This application must be completed according to the minimum requirement checklist below. This checklist is part of the rental application and must be included with the rental application. **Applications that do not meet the minimum requirements will not be placed in the processing queue and may be returned until all minimum requirements have been met.**

Rental applications should be submitted well in advance of the desired start date for the use of rental water. Rental applications may be processed as early as November 1 of the year prior to the intended use of rental water. Any rental application received on or before November 1 for use in the next year will be assigned a received date of November 1. Rental applications submitted more than one year in advance of the proposed start date for the use of rental water will not be accepted and will be returned to applicants. Rental applications may be returned to applicants if the desired start date for the use of rental water cannot be accommodated by the Water Supply Bank. Rental requests will not be accepted once the rental season of use period has concluded.

One rental application per beneficial use of water. For multiple beneficial uses of water, separate rental requests should be submitted for each unique beneficial use of water. One rental application can be submitted if you propose to rent water from multiple sources.

For additional instructions on completing a rental application, visit the Bank's website at http://idwr.idaho.gov/water_supply_bank.

MINIMUM REQUIREMENT CHECKLIST		
Check All Items as Either Attached (Yes) or Not Applicable (N/A)		
	Yes	
	<input checked="" type="checkbox"/>	Completed <i>Application to Rent Water from the Board's Water Supply Bank</i>
	<input checked="" type="checkbox"/>	Confirmation that this form has been printed single sided, per requirement of the Water Supply Bank
Attachment	N/A	Yes
2	<input checked="" type="checkbox"/>	A map showing the proposed point(s) of diversion, place(s) of use, and water diversion and distribution systems proposed to be used with your rental request
3A	<input type="checkbox"/>	<input checked="" type="checkbox"/> Detailed information on a proposed use of rental water
3F	<input type="checkbox"/>	<input type="checkbox"/> Authorization from the owner/operator of the rental point(s) of diversion
3H	<input type="checkbox"/>	<input type="checkbox"/> Water modeling to account for the impacts of the rental request
3J	<input checked="" type="checkbox"/>	<input type="checkbox"/> Documents justifying a rate of flow greater than 0.02 cfs/acre
3K	<input type="checkbox"/>	<input type="checkbox"/> Authorization from the owner/operator of the property at the proposed rental place(s) of use
4B	<input type="checkbox"/>	<input checked="" type="checkbox"/> Explanation of how the rental water will sufficiently accomplish your rental purposes
4C	<input checked="" type="checkbox"/>	<input type="checkbox"/> Explanation of consumptive use amounts for water rights experiencing a change in nature of use

Department Use Only – Proposed Water Right(s)

**STATE OF IDAHO
WATER RESOURCE BOARD**

Application to Rent Water (Continued)

1. CONTACT INFORMATION

A. Applicant WG Farms LLC, And WLR LC

Mailing Address 695 N 700 E Rupert ID 83350
Street City State Zip Code

Email Address Richardg@whitesidesdairy.com Phone Number 208-531-5104

B. Is this application being completed by an authorized representative on behalf of the applicant? Yes No
 If yes, representatives (includes company employees if the applicant is a corporation, as well as legal counsel or consultants) should provide their information below if they desire to be included on correspondence with the rental applicant.

Representative Richard Garner Professional Title Manager
 Organization Whitesides Land Ranch LLC Relationship to Applicant Tenant

Mailing Address 695 N 700 E
 Email Address richardg@whitesidesdairy.com Phone Number 208-219-0219

2. MAP

Create a map of the proposed point(s) of diversion, place(s) of use and water diversion, delivery and distribution systems. Make sure the rental place of use is outlined and annotated with legal land descriptions (Township, Range, Section and Quarter-Quarters) or with GPS coordinates. For irrigation purposes, mark the number of acres you desire to irrigate. Attach the map to this application and label it **Attachment 2**.

3. DESCRIPTION OF PROPOSED USE FOR RENTAL WATER

A. Describe why you desire to rent water and provide a detailed description of your proposed use. If the proposed use is not for irrigation, describe in detail how you determined the amount of rental water required. If the space below is insufficient, attach additional sheets as required and label them **Attachment 3A**:

This water will be used as mitigation by non-use, to enable our water usage in the water district Magic Vally
Ground Water Association under our required 3 year average of use

B. Enter the desired and/or minimum rates of flow, volume, or irrigable acres requested for your rental purposes:

Desired Rate (Cubic Feet/Second)	Desired Volume (Acre-Foot)	Minimum Rate* (Cubic Feet/Second)	Minimum Volume* (Acre-Foot)	Desired Acres (if applicable)
CFS	1741.1 AF	CFS	AF	AC

* Sometimes water rights provide an exceptionally low rate per acre and/or low volume per acre. This section is meant to establish an acceptable range of water sufficient for your proposed water use. Please see question 4B and complete if necessary.

C. This section must be completed in full. Enter the proposed start date and latest possible start date for using rental water as well as the number of years you would like to rent water. The latest possible start is the latest possible date by which you would be willing to pay for a rental and be able to benefit from utilizing rental water.

Desired Start Date (month/day/year)	Latest Possible Start Date (month/day/year)	*Mark Desired Rental Duration (Calendar Years)	**Applicant's preference if rental application cannot be processed prior to the latest possible start?
4-15-21	n/a	<input checked="" type="checkbox"/> 1 <input type="checkbox"/> 2 <input type="checkbox"/> 3 <input type="checkbox"/> 4 <input type="checkbox"/> 5	<input checked="" type="checkbox"/> Process application as soon as possible <input type="checkbox"/> Return application to applicant

* The number of years permissible for a rental is subject to the lease contract duration for the water right(s) being rented.
 ** Per Idaho Code 42-201, it is unlawful to divert or use water without a valid water right. Water Supply Bank rental applicants are not authorized to utilize rental water prior to the execution of an approved rental agreement. Rental requests may be returned to applicants if no water is available from the Bank to fulfill a rental request.

**STATE OF IDAHO
WATER RESOURCE BOARD**

Application to Rent Water (Continued)

D. Describe your water distribution system and how rental water will be delivered from the point(s) of diversion (POD) to the proposed place of use (POU):

The water will not actually need to be pumped, it will be used as a credit for mitigation by non-use

E. Describe the physical type (pump, headgate, etc.) and location of the POD from which rental water is proposed to be diverted:

POD Description	Water Source	Other Water Rights Diverted from this POD
7S22E25SESWNE		36-16562, 36-16568, 36-16571, 36-16577
		36-16574, 36-16586

If the POD(s) above are located where water is turned into a canal, lateral or ditch, or if they are located on your property but are serviced by water that is delivered via a canal, lateral or ditch, your rental request must include documented authorization from all relevant canal companies, irrigation districts and/or water delivery entities, confirming that they consent to your diversion of water from their system.

F. Has documented consent from all relevant water delivery entities been obtained? Yes N/A
If yes, include documented consent as Attachment 3F.

G. Do any POD(s) identified in Question 3E divert from a water source that may require water modeling? Yes No
Refer to the Water Modeling Requirements Information Sheet to determine if a rental POD may require water modeling.

H. Has water modeling been provided with your rental request? Yes N/A
If yes, label modeling Attachment 3 H.
Rental applications that require modeling will be returned if modeling is not provided.

I. Specify the desired beneficial use of water and the requested season of use or number of acres required:

- Irrigation 868 (number of acres) Duration: Subject to IDWR standard seasons of use
- Commercial from: _____ (mm/dd) to: _____ (mm/dd)
- Stockwater from: _____ (mm/dd) to: _____ (mm/dd)
- Industrial from: _____ (mm/dd) to: _____ (mm/dd)
- Other: _____ from: _____ (mm/dd) to: _____ (mm/dd)

J. For irrigation uses, do you propose to divert water at a rate greater than 0.02 cfs/acre? N/A Yes No
If yes, justify the rate of flow and attach any supporting documents as Attachment 3J. Justification may include information on soil composition, conveyance losses, crop type, irrigation systems, public access areas, etc. A rate of 0.03 cfs/acre is permissible for irrigation of 5 acres or less.

K. Do you own the land at the proposed rental place of use (POU)? Yes No
If no, attach documentation from the POU owner/operator confirming your authorization to use the POU and label it Attachment 3K.

L. List all other water rights and sources of water at the rental place of use for the same purpose, including privately owned water rights and water received from a municipal supplier, an irrigation district, a canal company or any other water delivery entity. Explain why additional water is required:

See ATTACHMENT 3L

STATE OF IDAHO
WATER RESOURCE BOARD

Application to Rent Water (Continued)

4. RENTAL REQUESTS FOR SPECIFIC WATER RIGHTS

A. Are you requesting to rent specific water rights?

Yes No

If yes, specify below the elements of the water rights you are requesting to rent. If no, continue to Question 4B.

Important Information: Diversion rates and volumes sought for rent must be proportionate to the per acre diversion rates and per acre volume limits of the water right under lease contract to the Water Supply Bank. Prior to completing this section, applicants should review all water right lease contracts and any active rental agreements to determine which elements of a water right are available to satisfy a rental request. Lease and rental documents are searchable via [IDWR's website](#).

Water rights identified below must either already be leased to the Bank or a lease proposal should accompany this rental request. **Rental requests for water rights not yet leased to the Bank will be returned if companion lease applications are not provided with the rental request.** For leased rights featuring combined limits, rentals must be consistent with combined diversion rate, volume or acre limits. Combined limits should be listed on a row below water right numbers.

Water Right Elements Leased to Water Supply Bank					Leased totals, minus water right elements involved in active rental agreements, equals water right elements available for rent	Water Supply Bank Rental Request		
Water Right Number (leave blank if sub-total of combined limits)	Nature of Use	Diversion Rate (CFS)	Volume (AF)	Acres (AC)		Diversion Rate (CFS)	Volume (AF)	Acres (AC)
36-7026						96.4	24.1	
36-2684						4.4	1.1	
36-4179						523.5	130.9	
43-13595						1116.8	357.4	
43-13597								
Applicants must ensure the requested rate per acre and volume per acre do not exceed the rate per acre and volume per acre limits of water rights leased to the Water Supply Bank					TOTAL	1741.1	435.3	
						CFS	AF	AC

**Attach multiple copies of this page if space above is insufficient to list all water rights requested to be rented on this application.*

B. If water right conditions, combined limits, or the sum of all water right elements being requested provide an unconventional duty of water (e.g., an unusually low rate per acre or volume per acre for irrigation use), explain how your proposed rental will sufficiently accomplish your intended purposes. Attach a separate page if space is insufficient and label it **Attachment 4B**:

C. Does your rental request propose to change the nature of use for any water right(s) being rented?

Yes No

If yes, explain how the water right(s) will be converted to new uses. Include the historic, consumptive use amounts for the water right being rented if you have it, as well as the new consumptive use amount for your proposed beneficial use. If space below is insufficient, attach a separate page and label it **Attachment 4C**:

STATE OF IDAHO
WATER RESOURCE BOARD

Application to Rent Water (Continued)

5. ADDITIONAL INFORMATION

A. Is this the first time that rental water is being requested for this purpose at the rental place of use? Yes No
If no, list previous rental requests/agreements and explain why you have not secured a permanent water right for your needs:

B. Have you or do you intend to submit an application for permit or transfer proposing a similar use as this rental? Yes No
If yes, describe:

C. Was this rental application submitted in response to a Notice of Violation (NOV) or a pending NOV? Yes No
If yes, describe the date and location of the NOV.

D. Additional Information

DECLARATION

I hereby assert that the information contained in this application is true to the best of my knowledge. I understand that any willful misrepresentations made in this application may result in rejection of the application or cancellation of an approval. I understand that if this rental application is approved, it will be subject to the provisions of Section 42-1766, Idaho Code and all applicable state and federal laws. I understand that the submission of a rental application provides no guarantee for approval of a rental agreement. I also understand that, per Idaho Code 42-201, it is unlawful to divert or use water without a valid water right and that I am not authorized to utilize water as proposed in this application prior to the execution of an approved rental agreement.

Signature of Applicant

WG Farms LLC, WLR LC
Printed Name of Applicant

3/29/21
Date

Signature of Representative

Richard Garner, Whitesides Land Ranch
Printed Name of Representative

3/29/21
Date

Mail to:

Idaho Department of Water Resources
P.O. Box 83720
Boise, ID 83720-0098

STATE OF IDAHO
WATER RESOURCE BOARD

Water Modeling Requirement Information Sheet

Information on water modeling requirements for rental requests within special administrative areas

Important information on requesting rental water within special administrative areas: Refer to the information below to determine whether the modeling of potential impacts from your rental request is necessary. Use Section 4 of the rental application to identify selected water rights. **If you submit an application to rent water from within a special administrative area and water modeling is required, your rental request will be returned if water modeling is not provided.**

Water modeling may be required when an application to rent water involves one of two scenarios:

Scenario 1: The rental request proposes to divert water from a regulated water source and/or within a special administrative area AND the distance between the rental point(s) of diversion (POD) and the POD(s) for the leased water right(s) is greater than the administratively established, acceptable distance.

Regulated water sources may areas include:

- A. Ground water resources within the modeled area of the Eastern Snake Plain Aquifer (ESPA) and tributary aquifers;
- B. Ground water within Ground Water Management Areas (GWMAs) or Critical Ground Water Areas (CGWAs);
- C. Water resources within other specified administrative areas, as established by the Idaho Water Resource Board (IWRB) or the Idaho Department of Water Resources.

The distance between any rental POD(s) and the POD(s) for a leased water right to be rented is important. On the ESPA, distance is measured in terms of model cells that cover an area of one square mile. Ground water modeling is not required if lease POD(s) and rental POD(s) are located within the same model cell or within adjacent model cells. If the lease and rental PODs are separated by more than one model cell groundwater modeling must be completed using the IDWR ESPA Transfer Tool and modeling results must be submitted with the rental application. ESPA modeling tools can be accessed and freely downloaded from IDWR's website by visiting: www.idwr.idaho.gov/WaterManagement/WaterRights/WaterRightTransfers/resources.htm.

Ground water modeling may be required within GWMAs, CGWAs or other regulated administrative areas. Applicants who desire to rent water within an established GWMA, CGWA or other regulated administrative area should consult IDWR's website before submitting their application to review the current status of administrative orders related to regulated administrative areas. Consult www.idwr.idaho.gov/WaterInformation/GroundWaterManagement/designated_areas.htm for information on GWMAs or CGWAs, visit <https://idwr.maps.arcgis.com/home/> to use mapping tools to find other regulated areas.

Applicants interested in renting water within a GWMA, CGWA or other regulated administrative areas should request water rights that have been leased into the Bank from within the same administrative area. Generally, the Bank will not permit a rental of water within a regulated administrative area if the leased water rights are not located within that same administrative area.

Scenario 2: A rental request proposes to divert water from a different but hydraulically connected water source.

Modeling situations may include:

- A. Rental requests that propose to divert surface water rights via ground water POD(s) (wells); and
- B. Rental requests that propose to divert ground water from one aquifer when the right being rented authorizes the diversion of ground water from a hydraulically connected, tributary aquifer.

Rental requests that propose to divert surface water rights from ground water points of diversion may be considered if ground water modeling establishes that the surface and ground water resources are directly and immediately hydraulically connected. An acceptable hydraulic connection occurs when at least 50 percent of the total depletions from a well are detectable from the original water source within a 24 hour period. The existing (leased) POD and proposed (rental) POD must be proximate such that diversion and use of water from the proposed POD would have substantially the same effect on the hydraulically-connected source as diversion and use of water from the original POD.

Requests to rent ground water across tributary aquifer sources may be considered if ground water modeling is provided to demonstrate that two aquifers are hydraulically connected and the anticipated impacts of diverting ground water from one source through the other is modeled accordingly.

For more information about rental application requirements, contact IDWR at (208) 287-4800.

ATTACHMENT 2



POD

© 2021 Google

S-3150-E

Google

Imagery Date: 6/3/2016 42°47'09.28"N 113°48'58.97"W elev - 4342 ft

ATTACHMENT 3L

Water Right

36-2138
36-7188
36-2139
36-7190
36-2137
36-7189
36-7531
36-7393
36-8107
36-2140
36-7191
36-2189
36-2134
36-8213
36-8258
36-8212
36-8259
36-8257
36-2061
36-2220
36-2501
36-2550
36-2315A
36-2315C
36-2315D
36-2315E
36-7399
36-2135
36-2136
36-2142A
36-7186
36-7187
36-16796
36-15380
36-2415A
36-15356A
36-16403
36-16563
36-16569
36-16572
36-16575
36-16578
36-16587

MAGIC VALLEY GROUNDWATER DISTRICT
2020 Measurement Report
 Summary Sheet

WHITESIDES LAND RANCH

				Water Rights				Points of Diversion				
Owner	Water Right #	Priority Date	Tier	Acres/Rt	Tier Allowed AF	Combined Acre Limit	WMIS #	POD	Div. Name	2018 Usage	2019 Usage	2020 Usage
WG FARMS LLC	36-2138	6/7/1951	1	128	242.4	158	100331	07S 25E 08 NESWNW	#8A	318.5	306.8	339.5
WG FARMS LLC	36-7188	5/19/1972	3	30	48.7							
WG FARMS LLC	36-2139	6/7/1951	1	112	213.4	156	100332	07S 25E 08 NESWSE	#8C	303.2	397.1	405.7
WG FARMS LLC	36-7190	5/19/1972	3	44	69.9							
WG FARMS LLC	36-2137	6/7/1951	1	110	208.9	239.5	100330	07S 25E 08 NESWNE	#8B	447.3	460.9	532.2
WG FARMS LLC	36-7189	6/29/1971	3	25	40.1							
WG FARMS LLC	36-7531	3/31/1975	3	80	128.0							
UNITED STATES OF AMERICA ACTING	36-2415B	2/18/1960	2	25	42.9							
WG FARMS LLC	36-7393	10/12/1973	3	47	74.9	312	100334	07S 25E 09 NWSESW	#9	502.6	540.3	604.8
WG FARMS LLC	36-8107	8/10/1982	3	46	73.0							
WG FARMS LLC	36-2140	6/7/1951	1	220	417.2							
WG FARMS LLC	36-7191	5/19/1972	3	39	62.1	153	100333	07S 25E 08 SENWSW	#8D	322.5	290.2	291.9
WG FARMS LLC	36-2189	2/25/1953	1	114	217.0							
WG FARMS LLC	36-2134	6/7/1951	1	295	560.5	4,382.7	100291	07S 24E 12 SESENE	#6	579.8	629.9	646.9
WG FARMS LLC	36-8213	6/22/1983	3	71	113.6		100292	07S 24E 13 SWSENE	#16	432.9	398.9	229.5
WG FARMS LLC	36-8258	12/6/1984	3	435	696.0		100293	07S 24E 14 NENE	#5	770.4	759.2	918.7
WG FARMS LLC	36-8259	12/6/1984	3	260	416.0		101178	07S 24E 14 SWNWSE	#4	1124.4	897.2	951.2
WG FARMS LLC	36-8212	6/22/1983	3	57	91.2		100312	07S 24E 24 NWNE	#1 & #2	721.2	717.3	783.3
WG FARMS LLC	36-8257	12/6/1984	3	233	372.8		100313	07S 24E 25 NWNWNW	#10	818.2	1139.7	1174.5
WG FARMS LLC	36-2061	2/20/1948	1	160	304.0		100314	07S 24E 25 SESESE	#11	505.6	250.1	68.0
WG FARMS LLC	36-2220	5/2/1953	1	152	288.8		100326	07S 25E 07 NESWNE	#7B	304.5	440.3	444.3
WG FARMS LLC	36-2501	7/25/1961	2	65	113.8		100327	07S 25E 07 NESWSE	#7C	245.7	148.7	250.6
WG FARMS LLC	36-2550	8/27/1962	2	217	379.8		100328	07S 25E 07 NWSENW	#7A	302.1	145.4	254.0
WG FARMS LLC	36-2315A	1/21/1957	2	254	444.5		100329	07S 25E 07 SWNESW	#7D	215.3	299.4	258.4
WG FARMS LLC	36-2315C	1/21/1957	2	62	108.5		100341	07S 25E 17 NESWNW	Mtn. Pump	265.8	156.8	182.5
WG FARMS LLC	36-2315D	1/21/1957	2	220	385.0		100343	07S 25E 18 NESESE	#14	372.1	526.3	682.8
WG FARMS LLC	36-2315E	1/21/1957	2	312	546.0		100344	07S 25E 18 SENESW	#15	435.2	449.3	535.7
WG FARMS LLC	36-7399	10/30/1973	3	320	512.0		100345	07S 25E 19 NESENW	#13	505.8	384.1	478.4
WG FARMS LLC	36-2135	6/7/1951	1	122	231.8							
WG FARMS LLC	36-2136	6/7/1951	1	160	304.0							
WG FARMS LLC	36-2142A	6/7/1951	1	140	266.0							

MAGIC VALLEY GROUNDWATER DISTRICT
2020 Measurement Report

Summary Sheet

Points of Diversion

Water Rights

Owner	Water Right #	Priority Date	Tier	Acres/Rt	Tier Allowed AF	Combined Acre Limit	WMIS #	POD	Div. Name	2018 Usage	2019 Usage	2020 Usage
WG FARMS LLC	36-7186	5/19/1972	3	0	0.0		100213	7S 22E 25SESWNE	FL Pump 2	1,345.1	1304.1	1352.1
WG FARMS LLC	36-7187	5/19/1972	3	20	32.0		100215	7S 22E 36SWSWSE	FL Pump 3	50.3	154.0	0.0
WG FARMS LLC	36-16796	1/21/1957	2	369	645.9							
WG FARMS LLC	36-15380	4/1/1974	3	18	28.8							
WG FARMS LLC	36-2415A	2/18/1960	2	269	469.9							
WG FARMS LLC	36-15356A	6/30/1973	3	12	19.4							
WG FARMS LLC	36-16403	2/20/1948	1	160	304.0							
WLR LC	36-16562	2/17/1948	1	171	324.2							
WLR LC	36-16568	2/8/1977	3	558	893.0							
WLR LC	36-16571	8/15/1952	1	19	36.6	868						
WLR LC	36-16577	2/20/1990	3	83	132.1							
WLR LC	36-16574	2/19/1952	1	32	61.7							
WLR LC	36-16586	3/15/1987	3	5	7.9							
WLR LC	36-16563	2/17/1948	1	46	87.2		100214	07S 22E 25 SWSWNE	FL pump 1	461.9	387.8	508.2
WLR LC	36-16569	2/8/1977	3	151	241.3							
WLR LC	36-16572	8/15/1952	1	7	13.1							
WLR LC	36-16575	2/19/1952	1	12	22.0							
WLR LC	36-16578	2/20/1990	3	29	45.9							
WLR LC	36-16587	3/15/1987	3	3	5.0							

Totals: 11350.1 11183.7 11893.3

Totals: 6516 11342.6 6516.2

2020 Over/Under	-550.7	Cumulative Over/Under	-399.5	2021 Usage Target	11342.6
-----------------	--------	-----------------------	--------	-------------------	---------

Total WR Acres	6516.2	Yearly Allowed (AF)	11342.6	2020 Pumped (AF)	11893.3
----------------	--------	---------------------	---------	------------------	---------

* Used PCC. Meter reading 0 GPM while pumping
 ** End reading lower than start. Assumed reset to 0 at the start of season
 *** readings provided by user



322 E Front Street, Suite 648, Boise ID 83702 • PO Box 83720, Boise ID 83720-0098
Phone: 208-287-4800 • Fax: 208-287-6700 • Email: idwrinfo@idwr.idaho.gov • Website: idwr.idaho.gov

Governor Brad Little

Director Gary Spackman

September 13, 2021

WG FARMS
WLR LC
695 N 700 E
RUPERT, ID 83350-8407

**RE: RENTAL OF WATER FROM THE WATER SUPPLY BANK
WATER RIGHT NO(S). 43-13595 & 43-13597 AGREEMENT 541**

Dear Renter:

Please find enclosed a receipt in the amount of **\$19,018.00** and a copy of a fully executed Water Supply Bank Rental Agreement in connection with the rental of 950 acre-feet of water for mitigation by non-use during 2021. Upon receipt of this fully executed agreement, you are authorized to divert water in compliance with the conditions of water use described in the agreement.

Pursuant to the Water Supply Bank Rules, 90% or \$17,116.20 of the rental fee will be paid to the lessor(s) and 10% or \$1,901.80 will be retained by the Department to offset administrative costs.

If you have any questions, please contact this office at bank@idwr.idaho.gov or (208) 287-4800.

Sincerely,

Amanda Johnson-Veibell

for
Water Supply Bank

Enclosures: Receipt No. C110440
Rental Agreement (copy)

c: Sascha Marston – Fiscal



322 E Front Street, Suite 648, Boise ID 83702 • PO Box 83720, Boise ID 83720-0098
Phone: 208-287-4800 • Fax: 208-287-6700 • Email: idwrinfo@idwr.idaho.gov • Website: idwr.idaho.gov

Governor Brad Little

Director Gary Spackman

August 6, 2021

WG FARMS
WLR LC
695 N 700 E
RUPERT, ID 83350-8407

**RE: APPLICATION TO RENT WATER FROM THE WATER SUPPLY BANK
WATER RIGHT NO(S). 43-13597 & 43-13595 AGREEMENT 541**

*****TIME SENSITIVE RESPONSE REQUIRED*****

Dear Applicant:

The Department of Water Resources acknowledges receipt of your application to rent water from the Water Supply Bank. **I have enclosed a Water Supply Bank Rental Agreement for your review and signature.** Upon signature and return of the original agreement, together with the rental fee described below, the Department will also sign the original agreement and return an executed copy to you. Execution of the agreement and compliance with the conditions of approval authorize diversion and use of water as provided in the agreement.

A rental fee of \$19,018.00 was calculated based on the current rental rate of \$20.00 per acre-foot times a diversion volume of 950 acre-feet.

Please send a check for \$19,018.00 made payable to the Idaho Department of Water Resources, **together with the signed rental agreement, within 14 days** so I can complete processing.

Pursuant to the Water Supply Bank Rules, 90% or \$17,116.20 of the rental fee will be paid to the lessor(s) and 10% or \$1,901.80 will be retained by the Department to offset administrative costs.

If you have any questions, please contact this office at bank@idwr.idaho.gov or (208) 287-4800.

Sincerely,

Amanda Johnson-Veibell

for
Water Supply Bank

Enclosure

c: IDWR Front Desk

Veibell, Amanda

From: Ferguson, Justin
Sent: Monday, May 3, 2021 10:47 AM
To: Skinner, Corey; Erickson, Nathan
Subject: WSB Rental - WG & WLR Farms
Attachments: Rental Map - WG & WLR Farms.pdf; Draft Agreement - WG & WLR Farms.docx; Rental Review Mem1.docx

Corey, Nathan,

Attached are the approval documents for WG & WLR Farms for a single year requesting a rental for mitigation through non-use. Please let me know if you have any comments of concerns within the next several days

Thank you!

Buyer, Remington

To: Richard Garner
Subject: RE: wsb application review

From: Richard Garner [mailto:richardg@whitesidesdairy.com]
Sent: Wednesday, March 31, 2021 9:20 AM
To: Buyer, Remington <Remington.Buyer@idwr.idaho.gov>
Subject: RE: wsb application review

Please review and submit if ok

Richard Garner
Whitesides Land Ranch
(208) 219-0219 Cell

From: [Buyer, Remington](#)
Sent: Friday, March 26, 2021 2:25 PM
To: [Richard Garner](#)
Subject: Re: wsb application review

Hi Richard,

The only thing missing on the application is the desired/required diversion volume. In order for IDWR to rent water rights to WG Farms LLC / WLR LC for mitigation by non-use, WG Farms LLC / WLR LC needs to provide evidence that they have a mitigation obligation. On question 3B, please enter in the volume of water you are looking to rent, for mitigation purposes. Also, please provide evidence of mitigation obligation (e.g. a letter from the Magic Valley Ground Water District).

-Remington

From: Richard Garner <richardg@whitesidesdairy.com>
Sent: Friday, March 26, 2021 12:08:54 PM
To: Buyer, Remington
Subject: wsb application review

Would you look over this and tell me if there is anything I have missed, Thanks

Richard Garner
Whitesides Land Ranch
(208) 219-0219 Cell